

A-1

U. S. Department of Agriculture

FOREST SERVICE

posted

Chipp

NATIONAL FOREST

A1

CORNERS OF THE PUBLIC SURVEY

T. 144 N R. 30 W 5' Mer.

Corner common to Sections

6 (39W) 31, 145N 30W, and 1 (T144N 1331W)

Corner consists of a Pipe Brass (not) in place

State condition Good

Dimensions above ground 6" inches.

Sketch grooves, letters, figures, or notches, on proper face or edge.

CARDINAL POSITION

DIAGONAL POSITION

T145N			
R30W			
S31			
S. 1 S 6			
R31 R30			
144 T144			
N	W	S	E

NW	SW	SE	NE

Mound of is located

Pits are located

Sketch markings of Bearing Trees (or Rocks) in proper box and fill blanks below, giving bearings from Corner to Trees and Distances in Links.

T144N R31W S. 31 CC

T144N R31W S. 6 CC

BT

BT

Species Aspen W. Oak

Diameter 8" 4"

Bearing S50W S22E

Distance 10' 19'

Do you believe this to be a genuine Land Office Corner? Yes

If not, why?

Paul Jeluzoff (Signature)

11/2/31

(Date)

(Title)

A-1

Corner again.

Give any further facts which will aid in finding this

chains distant.

from which this Corner bears

side of

tree inches diameter, on the

Metal Location Poster is on a

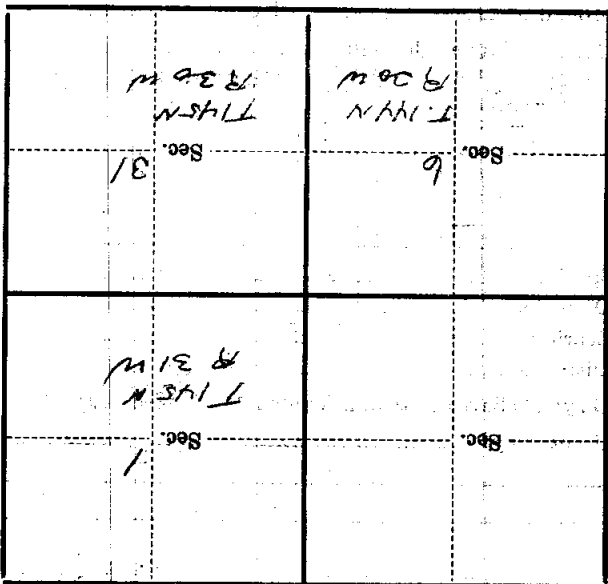

(Make sketch of topography near Corner)

T. 144 N R. 30 W
A-1 Met.