

Form 874-9—Revised May, 1918  
U. S. Department of Agriculture  
FOREST SERVICE

*Copied  
Pasted  
5/6*

NATIONAL FOREST  
CORNERS OF THE PUBLIC SURVEY

T. 144 R. 29 E. Mer.

N 1/4 Corner common to Sections  
North, side, 2, and

Corner consists of a 3" diameter Poplar stake (not) in place  
State condition

Dimensions above ground \_\_\_\_\_ inches  
Sketch grooves, letters, figures, or notches, on proper face or edge.

CARDINAL POSITION

DIAGONAL POSITION

--	--	--	--

N W S E

--	--	--	--

NW SW SE NE

Mound of \_\_\_\_\_ is located \_\_\_\_\_

Pits are located \_\_\_\_\_

Sketch markings of Bearing Trees (or Rocks) in proper box and fill blanks below, giving bearings from Corner to Trees and Distances in Links.

Species \_\_\_\_\_

Diameter \_\_\_\_\_

Bearing \_\_\_\_\_

Distance \_\_\_\_\_

Do you believe this to be a genuine Land Office Corner? \_\_\_\_\_

If not, why? \_\_\_\_\_

\_\_\_\_\_

\_\_\_\_\_

(Signature)

(Date)

8-7394

(Title)

A-19



Form 874-0—Revised May, 1918  
 U. S. Department of Agriculture  
 FOREST SERVICE

Chippewa NATIONAL FOREST

CORNERS OF THE PUBLIC SURVEY

T. 144N & 145R. 29W. 5 Mer.

N. 1/4

Corner common to Sections

....., and 2935

Corner consists of a 1 in pipe (not) in place

State condition good

Dimensions above ground 1.5" by 12" inches

Sketch grooves, letters, figures, or notches, on proper face or edge.

CARDINAL POSITION

DIAGONAL POSITION

<u>1/4</u>			
<u>cor</u>			
<u>nc</u>			
<u>3.2</u>			
N	W	S	E

NW	SW	SE	NE

Mound of ..... is located .....

Pits are located .....

Sketch markings of Bearing Trees (or Rocks) in proper box and fill blanks below, giving bearings from Corner to Trees and Distances in Links.

<u>1/45</u>	<u>1/4</u>		
<u>2</u>	<u>52</u>		
<u>BT</u>	<u>BT</u>		

Species open W. Pine

Diameter 7" 20"

Bearing 565W 565E

Distance 27 lks 39 lks.

Do you believe this to be a genuine Land Office Corner? yes

If not, why? .....

E. M. Handy

(Signature)

C. O. P.

(Date)

(Title)

Section 29 W. R. 14 N. T. 14 N. Mer. 5th

Metal Location Poster is on a tree inches diameter, on the side of from which this Corner bears chains distant. Give any further facts which will aid in finding this Corner again!

	Sec.		Sec.
	Sec.	2	Sec.

(Make sketch of topography near Corner)

U. S. Department of Agriculture  
FOREST SERVICE

Chippewa NATIONAL FOREST

CORNERS OF THE PUBLIC SURVEY

T. 144 N. <sup>1/4</sup> R. 29 W. 5 th. Mer.

N. 1/4 Corner common to Sections

....., and 2. ....

Corner consists of a Iron pipe (not) in place

State condition good

Dimensions above ground 1.5" by 12" inches

Sketch grooves, letters, figures, or notches, on proper face or edge.

CARDINAL POSITION

DIAGONAL POSITION

1/4 COR. NO 8.2			
--------------------------	--	--	--

--	--	--	--

N W S E

NW SW SE NE

Mound of ..... is located

Pits are located

Sketch markings of Bearing Trees (or Rocks) in proper box and fill blanks below, giving bearings from Corner to Trees and Distances in Links.

1/2 S	S 1/4		
BT	BT		

Species aspen W. Pine

Diameter 7" 20"

Bearing S65W S55E

Distance 27 lks 39 lks.

Do you believe this to be a genuine Land Office Corner? **yes**

If not, why?

*E. M. Handy*  
(Signature)

Chief of party

(Date)

(Title)

.....  
.....  
.....  
.....  
.....  
.....  
.....  
.....  
.....  
.....

Corner again.

Give any further facts which will aid in finding this  
chains distant.  
from which this Corner bears  
side of.  
tree..... inches diameter, on the  
Metal Location Poster is on a

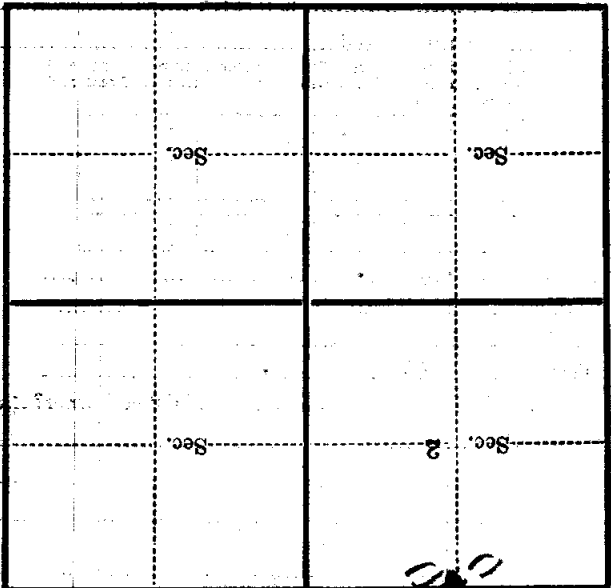

(Make sketch of topography near Corner)

U. S. Department of Agriculture  
FOREST SERVICE

Chippewa NATIONAL FOREST

CORNERS OF THE PUBLIC SURVEY

T. 144 & 145 R. 29 5<sup>th</sup> Mer.

1/4 Corner common to Sections  
2, and 35

Corner consists of a Iron Pipe (not) in place  
State condition good

Dimensions above ground 1.5" x 12" inches  
Sketch grooves, letters, figures, or notches, on proper face or edge.

CARDINAL POSITION

DIAGONAL POSITION

<u>1/4</u> <u>Cor.</u> <u>N.C.</u> <u>S.2.</u>			
N	W	S	E

NW	SW	SE	NE

Mound of \_\_\_\_\_ is located \_\_\_\_\_

Pits are located \_\_\_\_\_

Sketch markings of Bearing Trees (or Rocks) in proper box and fill blanks below, giving bearings from Corner to Trees and Distances in Links.

<u>1/4</u> <u>S.2</u>	<u>1/4</u> <u>S.2.</u>		
<u>B.T.</u>	<u>B.T.</u>		

Species Aspen W. Pine  
Diameter 7" 20"  
Bearing S.65W S.55E  
Distance 27 lks. 39 lks.

Do you believe this to be a genuine Land Office Corner? Yes  
If not, why? \_\_\_\_\_

E. M. Handy  
(Signature)

Chief of Party  
(Title)

(Date)

Corner again.

Metal Location Poster is on a tree inches diameter, on the side of from which this Corner bears chains distant. Give any further facts which will aid in finding this

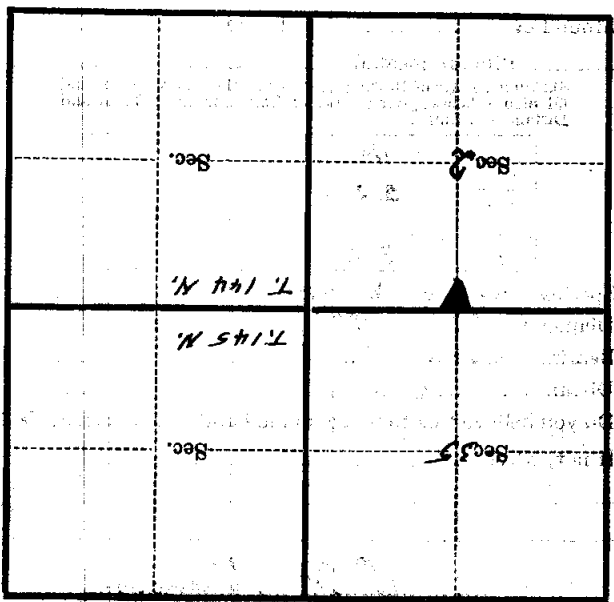

(Make sketch of topography near Corner)

T. 144 N. R. 29 5th Mer. A-19