

U. S. Department of Agriculture  
FOREST SERVICE

Chippewa NATIONAL FOREST  
CORNERS OF THE PUBLIC SURVEY

T. 144 R. 29 Mer.

S. 416 Corner common to Sections  
10, and 11

Corner consists of a iron pipe (not) in place  
State condition \_\_\_\_\_

Dimensions above ground 7 inches

Sketch grooves, letters, figures, or notches, on proper face or edge.

CARDINAL POSITION

DIAGONAL POSITION

N	W	S	E	NW	SW	SE	NE

Mound of \_\_\_\_\_ is located \_\_\_\_\_

Pits are located \_\_\_\_\_

Sketch markings of Bearing Trees (or Rocks) in proper box and fill blanks below, giving bearings from Corner to Trees and Distances in Links.

B.T.			

Species Cedar

Diameter 8 in

Bearing S. 87° E

Distance 0.30 ch.

Do you believe this to be a genuine Land Office Corner? \_\_\_\_\_

If not, why? \_\_\_\_\_

A. Friesen  
(Signature)

1/7/36  
(Date)

(Title) H-17

U. S. GEOLOGICAL SURVEY

U. S. GEOLOGICAL SURVEY

U. S. GEOLOGICAL SURVEY

CONTENTS OF THE PUBLIC SURVEY

1. Title page

2. Introduction

3. Description of the survey

4. List of stations

5. Description of the instruments

6. Description of the methods

7. Description of the results

8. Description of the conclusions

9. Description of the maps

10. Description of the plates

11. Description of the appendices

12. Description of the index

13. Description of the errata

14. Description of the notes

15. Description of the references

16. Description of the acknowledgments

17. Description of the preface

18. Description of the foreword

19. Description of the list of figures

20. Description of the list of tables

21. Description of the list of plates

22. Description of the list of appendices

23. Description of the list of index

24. Description of the list of errata

25. Description of the list of notes

26. Description of the list of references

(Make sketch of topography near Corner)

T. 144 R. 29 Mer.

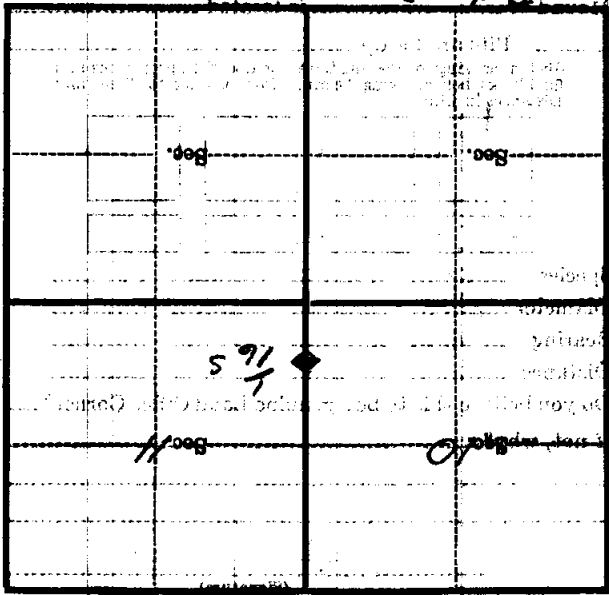

N 65-0 E

side of West

tree 1/4 inches diameter, on the

Metal Location marker is on a

Post

chains distant

Give any further facts which will aid in finding this

Corner again.

U. S. Department of Agriculture

FOREST SERVICE

NATIONAL FOREST

123

CORNERS OF THE PUBLIC SURVEY

T. 144 R. 29 Mer.

S. 1/16 Corner common to Sections

10, and 11

Corner consists of a Iron pipe (not) in place

State condition

Dimensions above ground 7 inches

Sketch grooves, letters, figures, or notches, on proper face or edge.

CARDINAL POSITION

DIAGONAL POSITION

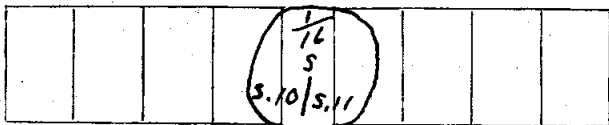

Mound of is located

Pits are located

Sketch markings of Bearing Trees (or Rocks) in proper box and fill blanks below, giving bearings from Corner to Trees and Distances in Links.



Species Cedar

Diameter 8 in.

Bearing S. 87° E.

Distance 0.30 ch.

Do you believe this to be a genuine Land Office Corner? yes

If not, why?

A. Friesen

(Signature)

7/7/36 (Date)

(Title)

Corner again.

Give any further facts which will aid in finding this

0.23 chains distant.

from which this Corner bears N 65° E

side of West

tree 14 inches diameter, on the

Metal Location Post on a 75h

put up

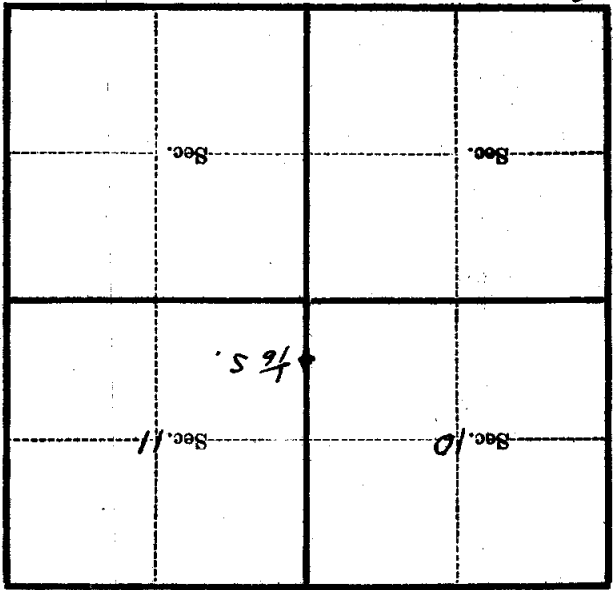

(Make sketch of topography near Corner)

T. 144 R. 29 Mer.

H-17