

Form 874-0—Revised May, 1918
U. S. Department of Agriculture
FOREST SERVICE

E-21

Chippewa NATIONAL FOREST
CORNERS OF THE PUBLIC SURVEY

T. 144 R. 28 5th Mer.

Sec. Corner common to Sections
1, 2, 11, and 12

Corner consists of a Squared tree (not) in place
State condition

Dimensions above ground 5' high 4" dia. inches
Sketch grooves, letters, figures, or notches, on proper face or edge.
CARDINAL POSITION DIAGONAL POSITION

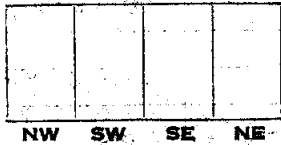

Mound of _____ is located _____

Pits are located _____

Sketch markings of Bearing Trees (or Rocks) in proper box and fill blanks below, giving bearings from Corner to Trees and Distances in Links.



Species Tam. Stump (rotted)
Diameter 7"
Bearing S 66 E
Distance 24 lks.

Do you believe this to be a genuine Land Office Corner? Yes
If not, why? _____

Dana F. Kirkman
(Signature)
Forest Ranger
(Title)

2/27/28
(Date)

Corner again.
 Corner is located at south edge of
 a open marsh in cedar of Tam
 along edge of timber. Good blazed
~~lines~~ line runs to E & W.
 Corner 10 chs. N. of this on
 edge of marsh. Squared stake,
 no other markings.

Give any further facts which will aid in finding this
 30 lbs. chains distant.

from which this Corner bears N. 13 W.
 side of Tree
 tree 5 inches diameter, on the N. 27 E.
 Metal Location Poster is on a Cedar

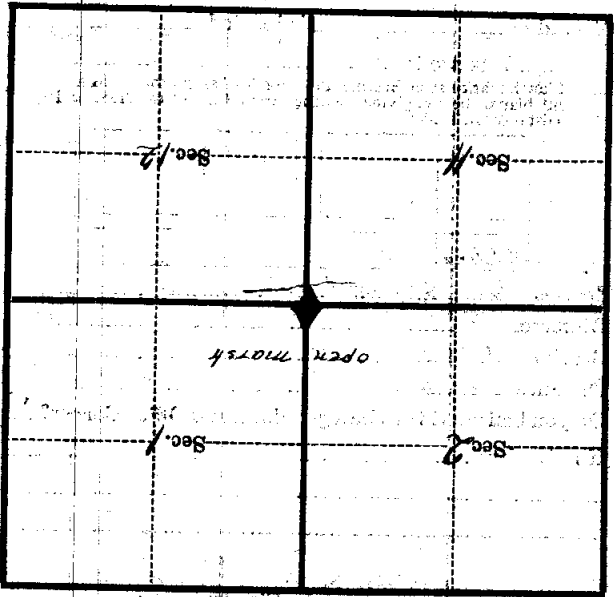

(Make sketch of topography near Corner)

T. 144 R. 28 Mer. 5 1/4

U. S. Department of Agriculture

FOREST SERVICE

E-21

Copy

NATIONAL FOREST

CORNERS OF THE PUBLIC SURVEY

T. 144 R. 28 Mer.

Sec Corner common to Sections 1, 2, 11, and 12

Corner consists of a 5' circular tree (not) in place
State condition _____

Dimensions above ground 5' high 4" Dia inches
Sketch grooves, letters, figures, or notches, on proper face or edge.

CARDINAL POSITION

DIAGONAL POSITION

--	--	--	--

N W S E

--	--	--	--

NW SW SE NE

Mound of _____ is located _____

Pits are located _____

Sketch markings of Bearing Trees (or Rocks) in proper box and fill blanks below, giving bearings from Corner to Trees and Distances in Links.

<u>Notched</u>			

Species Lacc. Stump - Rotted

Diameter 2"

Bearing S66E

Distance 24 1/2

Do you believe this to be a genuine Land Office Corner? Yes

If not, why? _____

Dana F. Kirkman

(Signature)

2-21-28

(Date)

F. R. R.
(Title)

U. S. Department of Agriculture

NATIONAL FOREST

Corner is located at south edge of a open
marsh is about 1/2 mile along edge of the
Good black bluffs was E-W
Corner is on W. of this on edge of
of marsh. *me-ny*
of marsh. *me-ny*

Corner again.
Give any further facts which will aid in finding this
Corner distant.
From which this corner bears *N 13 W*
side of *tree*
tree 6 inches diameter, on the *N 13 W*
Metal Location Poster is on a *Corner*

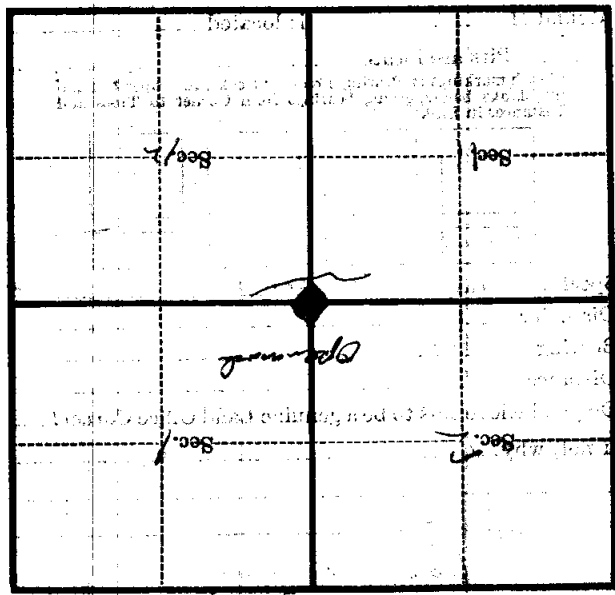

(Make sketch of topography near Corner)