

U. S. Department of Agriculture

FOREST SERVICE

J-17 P.R.

Chippewa NATIONAL FOREST

P. 123

CORNERS OF THE PUBLIC SURVEY

T. 144 N R. 28 W 5th Mer.

Section Corner Corner common to Sections

10, 11, 15, and 14

Corner consists of a squared stake (not) in place State condition partly decayed

Dimensions above ground 3.5' x 3.5' x 4' inches.

Sketch grooves, letters, figures, or notches, on proper face or edge.

CARDINAL POSITION

DIAGONAL POSITION



N W S E

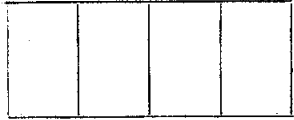

NW SW SE NE

Mound of is located

Pits are located

Sketch markings of Bearing Trees (or Rocks) in proper box and fill blanks below, giving bearings from Corner to Trees and Distances in Links.

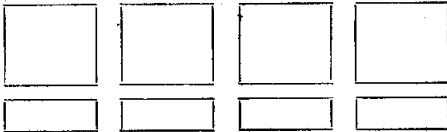

Species Birch Birch Cedar Cedar Diameter 8" 9" 7" 10" Bearing Distance 25' 22' 30' 27'

Do you believe this to be a genuine Land Office Corner? Yes

If not, why?

Paul Moeller

(Signature)

Technical Foreman

(Title)

Dec. 4, 1933

(Date)

J-17

5-14-12 The corner was set by
 Brown & Holt (Agents) & corner
 set by them - marked with a
 line running N 1/2 E. 120.0 feet
 3 - 200 ft. on the N. E. of the corner
 3 of S. E. 1/4 of the corner
 & corner

Corner again.

Give any further facts which will aid in finding this

chains distant.

25

from which this Corner bears West

side of the section corner

tree 9 inches diameter, on the East

Metal Location Poster is on a Birch - BT

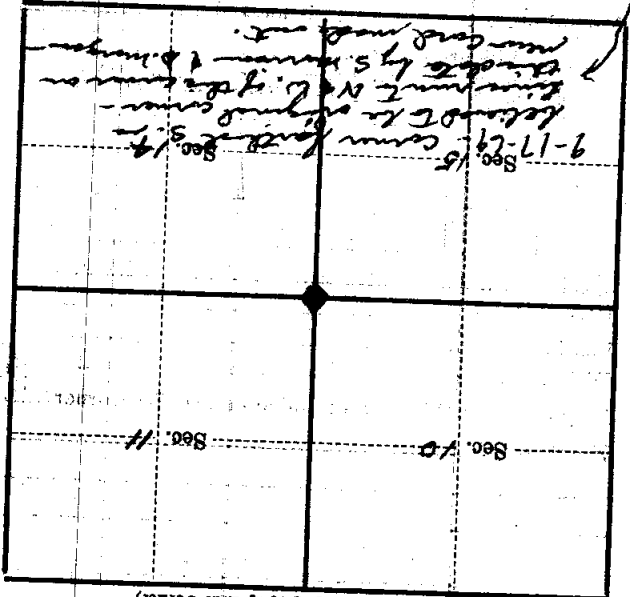

(Make sketch of topography near Corner)

already posted

Form 874-B—Revised May, 1918
U. S. Department of Agriculture
FOREST SERVICE

J-17

Chippewa NATIONAL FOREST
CORNERS OF THE PUBLIC SURVEY

T. 144 N, R. R 8 W 5th Mer.

section corner Corner common to Sections
10, 11, 15, and 14

Corner consists of a squared stake (not) in place
State condition partly decayed

Dimensions above ground 3.5 x 3.5 x 4 inches

Sketch grooves, letters, figures, or notches, on proper face or edge.

CARDINAL POSITION

DIAGONAL POSITION

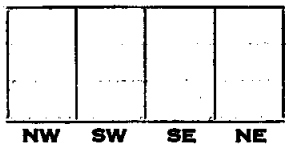
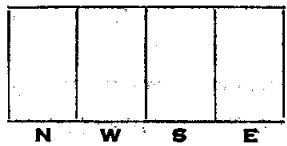

Mound of _____ is located _____

Pits are located _____

Sketch markings of Bearing Trees (or Rocks) in proper box and fill blanks below, giving bearings from Corner to Trees and Distances in Links.



Species Birch Birch Cedar Cedar

Diameter 8" 9" 7" 10"

Bearing _____

Distance 25 22 30 27

Do you believe this to be a genuine Land Office Corner? Yes

If not, why? _____

Paul Moeller

(Signature)

Dec 4, 1933

(Date)

Tech. Foreman

(Title)

UNITED STATES FOREST SERVICE
CORNER OF THE PUBLIC SQUARE

Corner again:
Give any further facts which will aid in finding this

25 chains distant
from which this Corner bears
side of *The section corner*
tree 9 inches diameter, on the *East*
Metal Location Poster is on a *Bitch-B.T.*

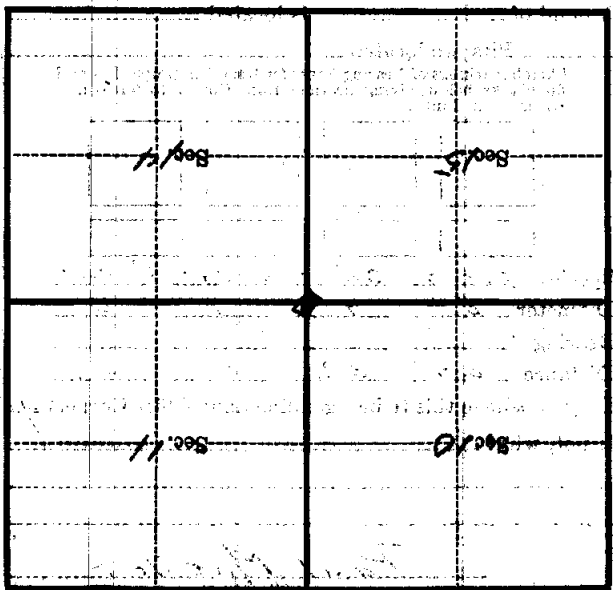

(Make sketch of topography near Corner)