

U. S. Department of Agriculture  
FOREST SERVICE

P 25

NATIONAL FOREST

CORNERS OF THE PUBLIC SURVEY

T. 144 R. 27 Mer.

47 Corner common to Sections

27, and 19 T144 R26

Corner consists of a Brass Cap + Iron Pipe in place

State condition good

Dimensions above ground 6 inches

Sketch grooves, letters, figures, or notches, on proper face or edge.

CARDINAL POSITION

DIAGONAL POSITION

--	--	--	--

N W S E

--	--	--	--

NW SW SE NE

Mound of \_\_\_\_\_ is located \_\_\_\_\_

Pits are located \_\_\_\_\_

Sketch markings of Bearing Trees (or Rocks) in proper box and fill blanks below, giving bearings from Corner to Trees and Distances in Links.

Species W.P. Cmb.

Diameter 10" 10"

Bearing N45E S10W

Distance 6' 24'

Do you believe this to be a genuine Land Office Corner? Yes

If not, why? \_\_\_\_\_

*R. H. ...*  
(Signature)

1-16-58  
(Date)

D. P. R.  
(Title)

Corner again.  
B. H. T. S. of corner  
+ 12' west of logging rd has  
Tag. Log to N.E. is also cut  
about 1956. Lines Blended  
+ West.

Give any further facts which will aid in finding this  
chains distant.  
from which this Corner bears  
side of  
tree inches diameter, on the  
Metal Location Poster is on a W.D. B. tree.

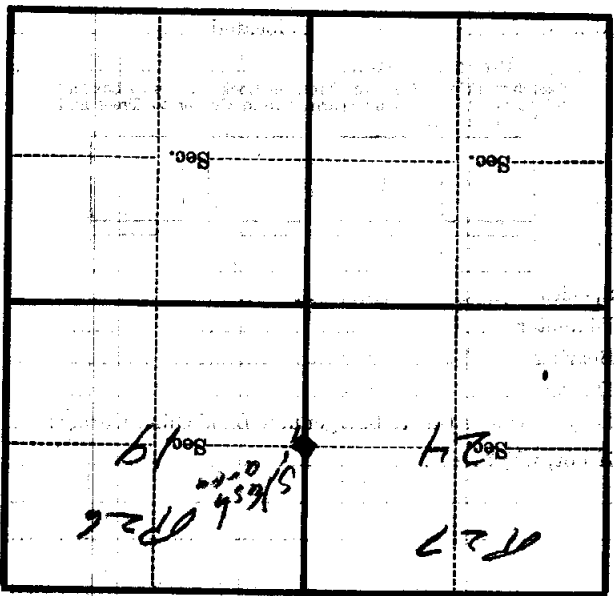

(Make sketch of topography near Corner)