

Form 874-9—Revised May, 1918  
 U. S. Department of Agriculture  
 FOREST SERVICE

E-11

Chippewa NATIONAL FOREST  
 CORNERS OF THE PUBLIC SURVEY

T. 144 R. 26 Mer.

1/4 Corner common to Sections  
 \_\_\_\_\_, \_\_\_\_\_, 4, and 9

Corner consists of a square Tamm (not) in place  
 State condition Good

Dimensions above ground 30 inches  
 Sketch grooves, letters, figures, or notches, on proper face or edge.

CARDINAL POSITION

	<u>1/4</u>		<u>1/4</u>
N	W	S	E

DIAGONAL POSITION

NW	SW	SE	NE

Mound of \_\_\_\_\_ is located \_\_\_\_\_

Pits are located \_\_\_\_\_

Sketch markings of Bearing Trees (or Rocks) in proper box and fill blanks below, giving bearings from Corner to Trees and Distances in Links.

<u>1/4</u>		<u>1/4</u>	
<u>5</u>		<u>5</u>	
<u>B.T.</u>		<u>B.T.</u>	

Species Tamm Tamm

Diameter 7 in. 7 in.

Bearing N. 10° W S 61° E

Distance 0.26 ch. 0.28 ch.

Do you believe this to be a genuine Land Office Corner? yes

If not, why? \_\_\_\_\_

Frieser  
 (Signature)

12/4/35  
 (Date)

Section 9  
T. 14 N.  
R. 26 E.  
S. 10 N.  
S. 11 N.  
S. 12 N.  
S. 13 N.  
S. 14 N.  
S. 15 N.  
S. 16 N.  
S. 17 N.  
S. 18 N.  
S. 19 N.  
S. 20 N.

Corner again.  
Give any further facts which will aid in finding this  
chain distant.  
0.07  
from which this Corner bears  
N. 57.0 W.  
side of Tree  
tree 3 inches diameter, on the  
Metal Location Poster on a  
T.M.

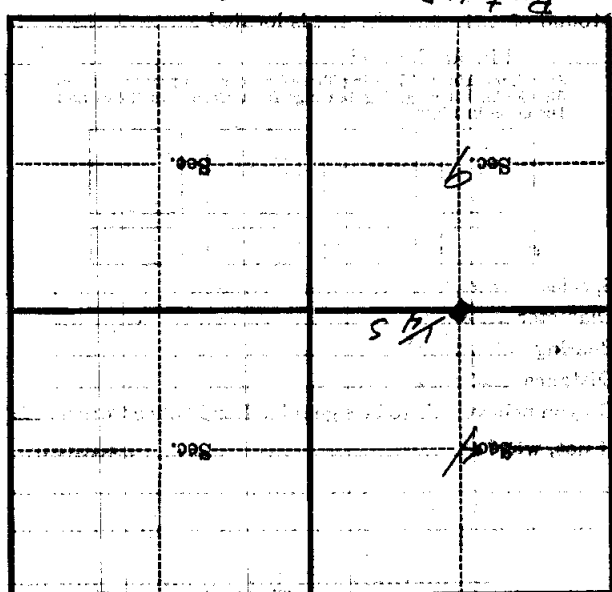

(Make sketch of topography near Corner)

Form 874-2—Revised May, 1918  
U. S. Department of Agriculture  
FOREST SERVICE

123

E-11

NATIONAL FOREST

CORNERS OF THE PUBLIC SURVEY

T. 144 R. 26 Mer.

Corner common to Sections 4 and 9

Corner consists of a S. Q. Tam. (rock) in place

State condition Good

Dimensions above ground 30 inches

Sketch grooves, letters, figures, or notches, on proper face or edge.

CARDINAL POSITION

DIAGONAL POSITION

	$\frac{1}{4}$ S		$\frac{1}{4}$ S
N	W	S	E

NW	SW	SE	NE

Mound of \_\_\_\_\_ is located \_\_\_\_\_

Pits are located \_\_\_\_\_

Sketch markings of Bearing Trees (or Rocks) in proper box and fill blanks below, giving bearings from Corner to Trees and Distances in Links.

$\frac{1}{4}$ S		$\frac{1}{4}$ S	
BT		BT	

Species Tam. snag Tam.

Diameter 7 in. 7 in.

Bearing N 12° W S 61° E

Distance 0.26 ch. 0.25 ch.

Do you believe this to be a genuine Land Office Corner? Yes

If not, why? \_\_\_\_\_

Friesen

(Signature)

12/4/35

(Date)

(Title)

E-11

(Make sketch of topography near Corner)

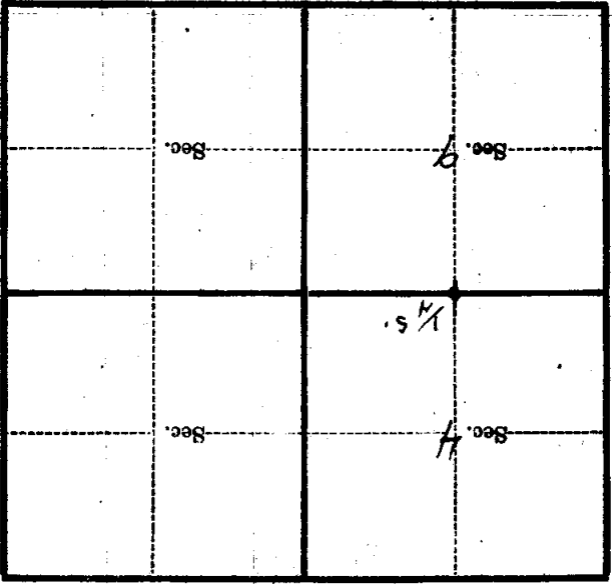

Put up

Metal Location Poster on a T.M.

tree 3 inches diameter, on the South-east

side of Trees

from which this Corner bears N. 57° W

0.07 chains distant.

Give any further facts which will aid in finding this

Corner again.