

Form 874-9—Revised May, 1918
U. S. Department of Agriculture
FOREST SERVICE

✓
Chippewa NATIONAL FOREST

CORNERS OF THE PUBLIC SURVEY

T. 144N R. 26W 5th P. Mer.

Sec Corner common to Sections
28, 29, 32, and 33

Corner consists of a Iron Pipe (not) in place
State condition Good

Dimensions above ground 18" inches

Sketch grooves, letters, figures, or notches, on proper face or edge.

CARDINAL POSITION

DIAGONAL POSITION

--	--	--	--

N W S E

--	--	--	--

NW SW SE NE

Mound of _____ is located _____

Pits are located _____

Sketch markings of Bearing Trees (or Rocks) in proper box and fill blanks below, giving bearings from Corner to Trees and Distances in Links.

Species _____

Diameter _____

Bearing _____

Distance _____

Do you believe this to be a genuine Land Office Corner? Yes

If not, why? _____

H. A. Brills

(Signature)

7/16/34

(Date)

C. O. P.

(Title)

Metal Location Poster is on a **Hand Stake**

tree _____ inches diameter, on the _____ side of _____ from which this Corner bears _____ chains distant.

Give any further facts which will aid in finding this Corner again.

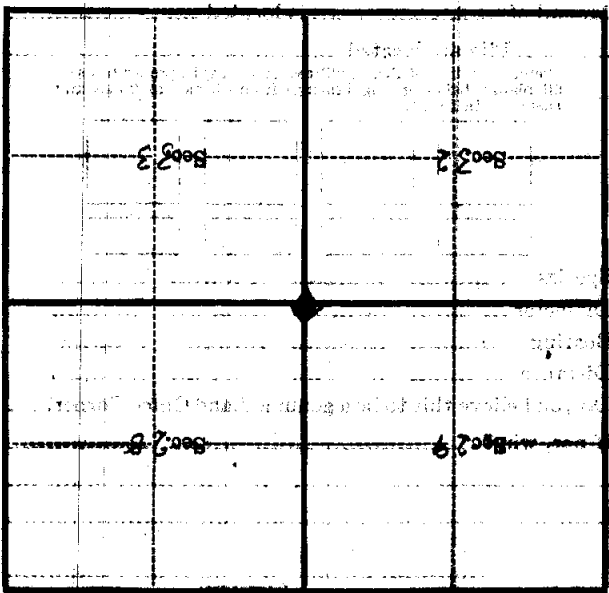

(Make sketch of topography near Corner)

Form 874-9—Revised May, 1918
U. S. Department of Agriculture
FOREST SERVICE

123

CHIPPEWA NATIONAL FOREST

P.

CORNERS OF THE PUBLIC SURVEY

T. 144 R. 26 Mer.

Section Corner common to Sections

28, 29, 32, and 33

Corner consists of a ~~Iron pipe~~ (not) in place

State condition Good

Dimensions above ground 18 inches.

Sketch grooves, letters, figures, or notches, on proper face or edge.

CARDINAL POSITION

DIAGONAL POSITION

N	W	S	E

NW	SW	SE	NE

Mound of _____ is located _____

Pits are located _____

Sketch markings of Bearing Trees (or Rocks) in proper box and fill blanks below, giving bearings from Corner to Trees and Distances in Links.

Species _____

Diameter _____

Bearing _____

Distance _____

Do you believe this to be a genuine Land Office Corner? **Yes**

If not, why? _____

H. A. Brigg

(Signature)

Chief of Party

(Title)

7/16/34

(Date)

V-9

Corner again.

Give any further facts which will aid in finding this

~~chains distant~~

~~from which this Corner bears~~

~~side of~~

~~tree inches diameter, on the~~

Metal Location Poster is on a *Gravel Stake*

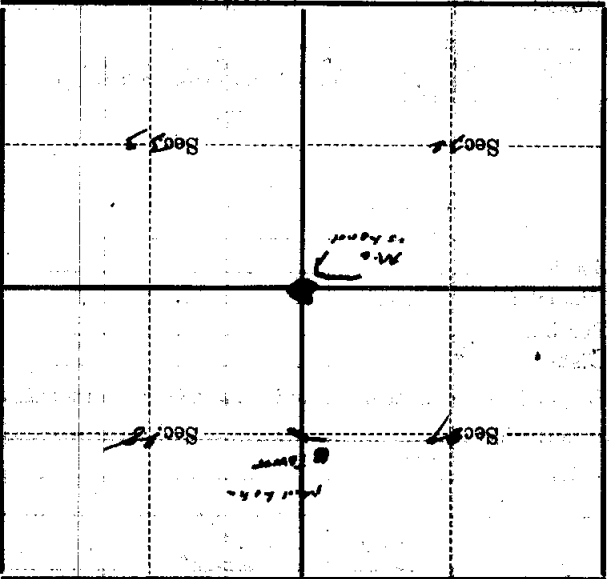

(Make sketch of topography near Corner)

Form 874-9—Revised May, 1918
 U. S. Department of Agriculture
 FOREST SERVICE

C.P.
 5
 36

----- NATIONAL FOREST

CORNERS OF THE PUBLIC SURVEY

T. 144 R. 26 S. 5 Mer.

----- Corner common to Sections

28, 29, 32, and 33

Corner consists of iron stake (not) in place

State condition -----

Dimensions above ground ----- inches

Sketch grooves, letters, figures, or notches, on proper face or edge.

CARDINAL POSITION

DIAGONAL POSITION

--	--	--	--

--	--	--	--

N W S E

NW SW SE NE

Mound of ----- is located -----

----- Pits are located -----

Sketch markings of Bearing Trees (or Rocks) in proper box and fill blanks below, giving bearings from Corner to Trees and Distances in Links.

Species -----

Diameter -----

Bearing -----

Distance -----

Do you believe this to be a genuine Land Office Corner? -----

If not, why? -----

----- (Signature)

----- (Date)

----- (Title)

UNITED STATES GEOLOGICAL SURVEY

WATER RESOURCES DIVISION

Form No. 10 (Rev. 1-25-60)

LOCATION OF THE CORNER

AND

Corner again.

Give any further facts which will aid in finding this

chain's distant

from which this Corner bears

side of

tree inches diameter, on the

Metal Location Poster is on a

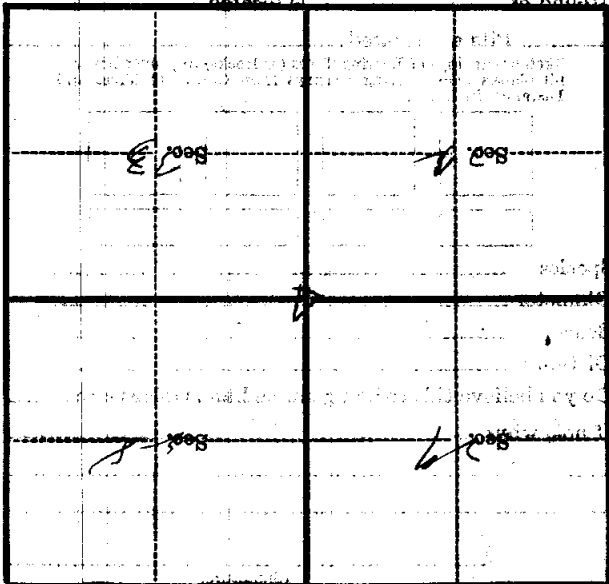

(Make sketch of topography near Corner)

U. S. Department of Agriculture

FOREST SERVICE

Chippewa NATIONAL FOREST

CORNERS OF THE PUBLIC SURVEY

T. 144 R. 26 5th Mer.

Sec. Corner common to Sections

28, 29, 32, and 33

Corner consists of a Iron Pipe (not) in place

State condition Good

Dimensions above ground 18 inches

Sketch grooves, letters, figures, or notches, on proper face or edge.

CARDINAL POSITION

DIAGONAL POSITION

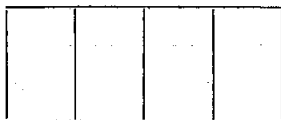
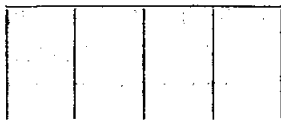

N W S E

NW SW SE NE

Mound of is located

Pits are located

Sketch markings of Bearing Trees (or Rocks) in proper box and fill blanks below, giving bearings from Corner to Trees and Distances in Links.

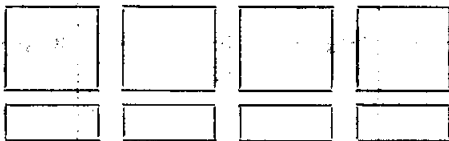

Species

Diameter

Bearing

Distance

Do you believe this to be a genuine Land Office Corner? Yes

If not, why?

H.A. Brills (Signature)

Chief of Party (Title)

7/16/34 (Date)

Corner again.

Give any further facts which will aid in finding this

chains distant.

from which this Corner bears

side of

tree inches diameter, on the

Metal Location Poster is on a Guard Stake

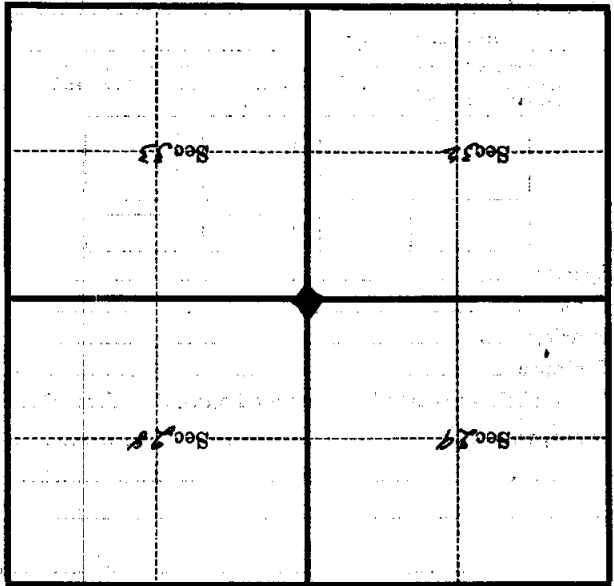

(Make sketch of topography near Corner)