

U. S. Department of Agriculture

FOREST SERVICE

NATIONAL FOREST

D-4

CORNERS OF THE PUBLIC SURVEY

T. 144 R. 26 Mer.

S.E. 1/6 Corner common to Section

6, and

Corner consists of a (not) in place

State condition

Dimensions above ground inches

Sketch grooves, letters, figures, or notches, on proper face or edge.

CARDINAL POSITION

DIAGONAL POSITION

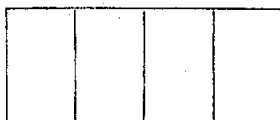
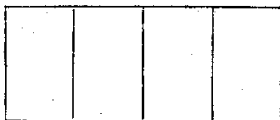

N W S E

NW SW SE NE

Mound of is located

Pits are located

Sketch markings of Bearing Trees (or Rocks) in proper box and fill blanks below, giving bearings from Corner to Trees and Distances in Links.



Species Asped

Diameter 14 in

Bearing N 70° W

Distance 0.12 ch.

Do you believe this to be a genuine Land Office Corner? Yes

If not, why?

A. Friesen

(Signature)

11/7/35 (Date)

Corner again.

Give any further facts which will aid in finding this

chains distant. 0.20

from which this Corner bears S. 51° W.

side of Tree

tree 16 inches diameter, on the E.

put up Metal Location Poster on a P. pine

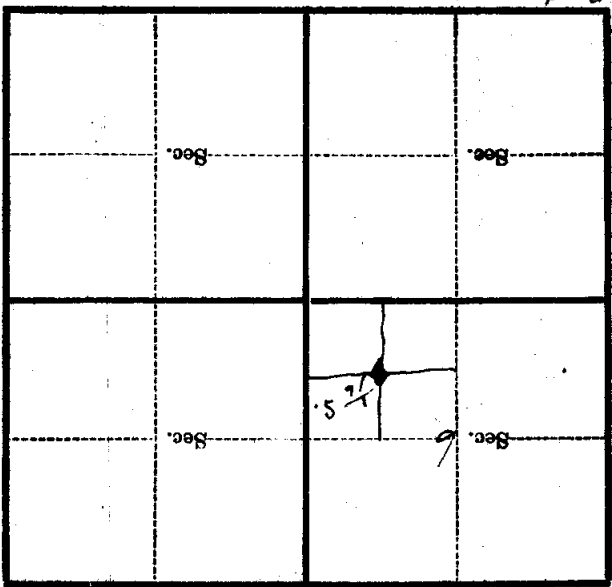

(Make sketch of topography near Corner)

Mer.

T. 144 R. 96

U. S. Department of Agriculture

FOREST SERVICE

Chippewa NATIONAL FOREST

D-4

CORNERS OF THE PUBLIC SURVEY

T. 144N R. 26W S⁴P Mer.
SE 1/16 Corner common to Sections

_____, _____, _____, and 6

Corner consists of a _____ (not) in place
State condition _____

Dimensions above ground _____ inches
Sketch grooves, letters, figures, or notches, on proper face or edge.

CARDINAL POSITION

DIAGONAL POSITION

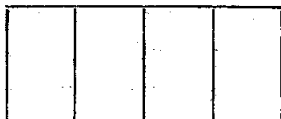

N W S E

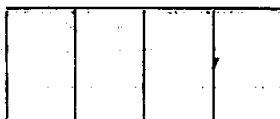

NW SW SE NE

Mound of _____ is located _____

Pits are located _____

Sketch markings of Bearing Trees (or Rocks) in proper box and fill blanks below, giving bearings from Corner to Trees and Distances in Links.



Species A.S.P.R. _____

Diameter 1 1/2" _____

Bearing N72W _____

Distance 12 Lks. _____

Do you believe this to be a genuine Land Office Corner? Yes

If not, why? _____

A. Friesen

(Signature)

C.O.R

(Title)

11/7/35
(Date)

SECTION 6

SECTION 5

SECTION 4

Corner again.

Give any further facts which will aid in finding this

chain distant.

From which this Corner bears *S. 51.° W.*

side of *Tree*

tree *16* inches diameter, on the *E*

Metal Location Poster on a *Line*

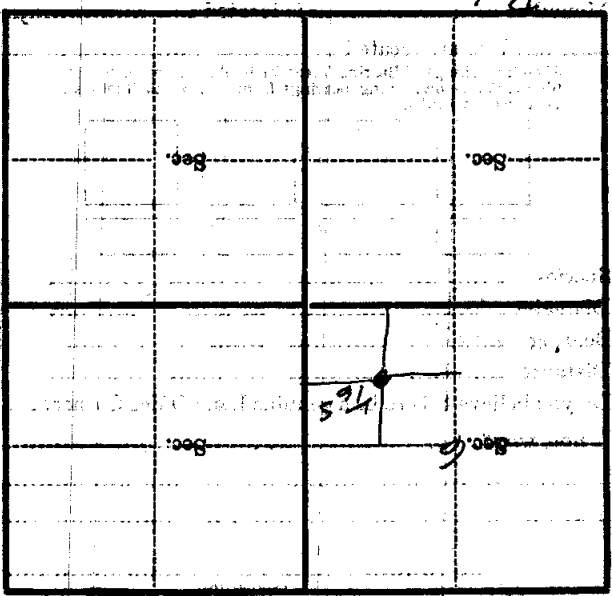

(Make sketch of topography near Corner)

T. 14 N. R. 26 W. Mer.