

U. S. Department of Agriculture

FOREST SERVICE

A-3

NATIONAL FOREST

CORNERS OF THE PUBLIC SURVEY

T. 144+145 R. 26 Mer.

Corner common to Sections

31

and

Corner consists of a ^{square} cedar stake (not) in place

State condition badly decayed

Dimensions above ground 18 inches

Sketch grooves, letters, figures, or notches, on proper face or edge.

CARDINAL POSITION

DIAGONAL POSITION

<u>1/4</u>			
<u>S</u>			
N	W	S	E

NW	SW	SE	NE

Mound of _____ is located _____

Pits are located _____

Sketch markings of Bearing Trees (or Rocks) in proper box and fill blanks below, giving bearings from Corner to Trees and Distances in Links.

Species _____

Diameter no bearing trees

Bearing _____

Distance _____

Do you believe this to be a genuine Land Office Corner? yes

~~If not, why?~~ There was more scribing on stake, but it was unreadable

Albert Friesen
(Signature)

10/11/35
(Date)

Corner again.
 This cor. is 40.45 chs.
 E. of P.D. Sec. cor. of
 31 + 36.
 Put 4" dia. square cedar
 stake 36" above ground
 beside E.T.D. cor. post.

Give any further facts which will aid in finding this
 chains distant.
 from which this Corner bears
 N 33° W
 side of
 tree 3 inches diameter, on the
 Metal Location Poster on a
 T.A.M.
 put up

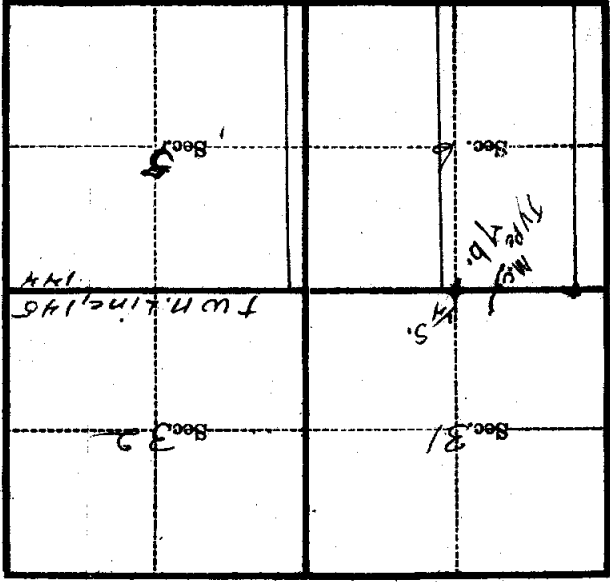

(Make sketch of topography near Corner)