

U. S. Department of Agriculture

FOREST SERVICE

Chippewa NATIONAL FOREST
CORNERS OF THE PUBLIC SURVEYT. 144 R. 26 5th Mer. $\frac{1}{4}$ Corner common to Sections
30, and 31Corner consists of a Brass, copper Pipe (not) in place
State condition

Dimensions above ground 16" inches

Sketch grooves, letters, figures, or notches, on proper face or edge.

CARDINAL POSITION

DIAGONAL POSITION

N	W	S	E

NW	SW	SE	NE

Mound of _____ is located _____

Pits are located _____

Sketch markings of Bearing Trees (or Rocks) in proper box and
fill blanks below, giving bearings from Corner to Trees and
Distances in Links.

Species Bur. Oak.Diameter 16"Bearing S. 88 W.Distance 15 ch. 18 lks.Do you believe this to be a genuine Land Office Corner? No.If not, why? Resurvey cornerby war. department.C. B. Stott.

(Signature)

11/19/27

(Date)

J. F.

(Title)

Corner again.

Give any further facts which will aid in finding this
chains distant.
from which this Corner bears
side of
tree inches diameter, on the *As described*
Metal Location Poster is on a *B.T. Burr Oak.*

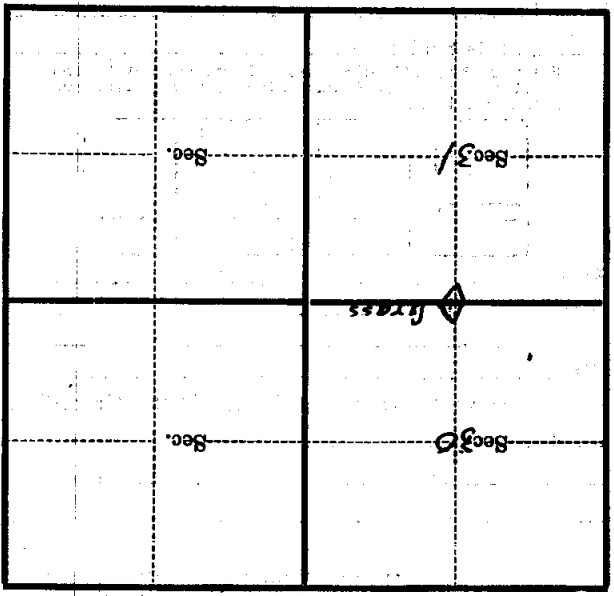

(Make sketch of topography near Corner)

U. S. Department of Agriculture
FOREST SERVICE

11-16-36

Chippewa NATIONAL FOREST

CORNERS OF THE PUBLIC SURVEY

T. 144 R. 26 5th Mer.

1/4 Corner common to Sections
30, and 31

Corner consists of a Brass, Copper Pipe (not) in place
State condition

Dimensions above ground 16" inches

Sketch grooves, letters, figures, or notches, on proper face or edge.

CARDINAL POSITION

DIAGONAL POSITION

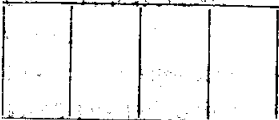

N W S E

NW SW SE NE

Mound of _____ is located _____

Pits are located _____

Sketch markings of Bearing Trees (or Rocks) in proper box and fill blanks below, giving bearings from Corner to Trees and Distances in Links.

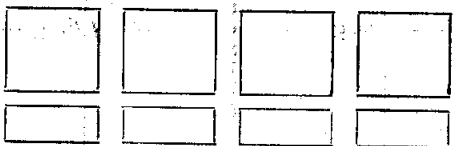

Species Bur Oak

Diameter 16"

Bearing S. 88 W

Distance 5 Ch. 18 lks.

Do you believe this to be a genuine Land Office Corner? No

If not, why? Resurvey corner by war department.

C. B. Stott

(Signature)

J. F.

(Title)

11/19/27
(Date)

V-3

U. S. Department of Agriculture

FOREST SERVICE

OFFICE OF THE FOREST ENGINEER

COMMISSIONERS OF THE PUBLIC LANDS

WASHINGTON, D. C.

NOV 19 1914

TO THE FOREST ENGINEER

WASHINGTON, D. C.

Corner again.

Give any further facts which will aid in finding this

chains distant.

from which this Corner bears

side of

tree inches diameter, on the *As described*

Metal Location Poster is on a *B.T. Bum Oak*

100 200 300 400 500 600 700 800 900 1000

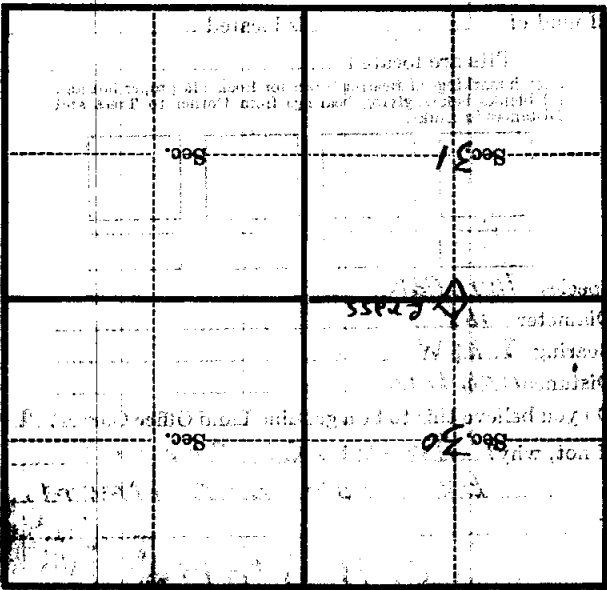

(Make sketch of topography near Corner)