

Form 874-B—Revised May, 1918  
U. S. Department of Agriculture  
FOREST SERVICE

Chippewa NATIONAL FOREST

CORNERS OF THE PUBLIC SURVEY

T. 144N R. 26W 5th P Mer.

1/4 Corner common to Sections  
31, and

Corner consists of a sq. stake (not) in place  
State condition badly decayed

Dimensions above ground \_\_\_\_\_ inches  
Sketch grooves, letters, figures, or notches, on proper face or edge.

CARDINAL POSITION

DIAGONAL POSITION

1/4			
S			
N	W	S	E

NW	SW	SE	NE

Mound of \_\_\_\_\_ is located \_\_\_\_\_

Pits are located \_\_\_\_\_

Sketch markings of Bearing Trees (or Rocks) in proper box and fill blanks below, giving bearings from Corner to Trees and Distances in Links.

Species \_\_\_\_\_

Diameter No bearing trees

Bearing \_\_\_\_\_

Distance \_\_\_\_\_

Do you believe this to be a genuine Land Office Corner? Yes

If not, why? There was more scribbling on stake but it was unreadable

A. Friesen

(Signature)

C.O.P.

(Title)

10/11/35

(Date)

CORNER OF THE PUBLIC SURVEY

Corner Agency  
County of ... State of ...  
Sec. ... T. ...

Diagonal Position  
From which this Corner bears  
side of tree  
tree 3 inches diameter, on the

NE 3/4  
30 1/4  
M 1/2

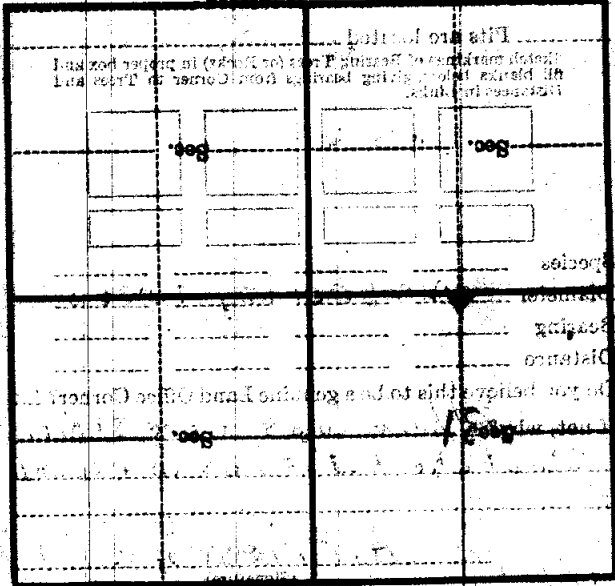

(Scale sketch of topography near Corner)