

U. S. Department of Agriculture

FOREST SERVICE

11-18-26  
123

Chippewa NATIONAL FOREST

CORNERS OF THE PUBLIC SURVEY

T. 144 R. 25-26 5 Mer.

Section Corner common to Sections 12, 7, 13, and 18

Corner consists of a Witness Tree(not) in place

State condition good

Dimensions above ground \_\_\_\_\_ inches

Sketch grooves, letters, figures, or notches, on proper face or edge.

CARDINAL POSITION

DIAGONAL POSITION

--	--	--	--

N W S E

--	--	--	--

NW SW SE NE

Mound of \_\_\_\_\_ is located \_\_\_\_\_

Pits are located \_\_\_\_\_

Sketch markings of Bearing Trees (or Rocks) in proper box and fill blanks below, giving bearings from Corner to Trees and Distances in Links.

Species EIM

Diameter 16" D.B.H.

Bearing S E of Cor.

Distance 50 Links

Do you believe this to be a genuine Land Office Corner? Yes

If not, why? \_\_\_\_\_

Norman F. Shaw

(Signature)

Engineer

(Title)

Mar. 7-35

(Date)

Faint, illegible text at the top of the page, possibly bleed-through from the reverse side.

Corner again.

Give any further facts which will aid in finding this

chains distant.

50  
from which this Corner bears North West  
side of Road  
tree 16" inches diameter, on the East  
Metal Location Poster is on a Witness Tree

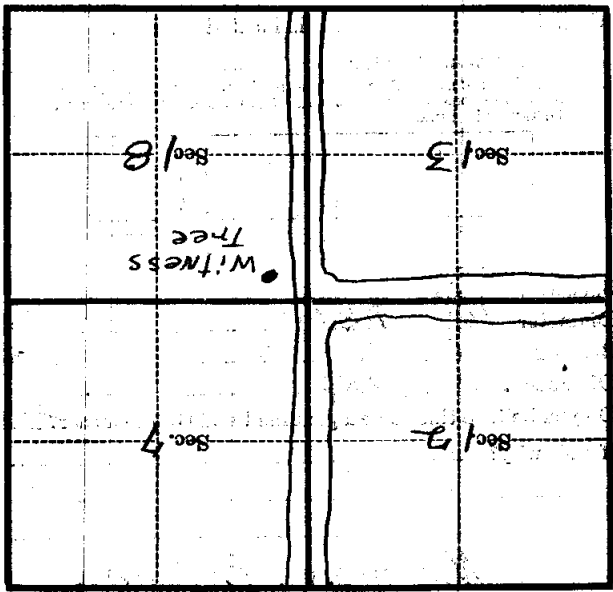

(Make sketch of topography near Corner)