

U. S. Department of Agriculture  
FOREST SERVICE

Postal J21

Chippewa NATIONAL FOREST

CORNERS OF THE PUBLIC SURVEY

T. 143 N R. 31 W 5<sup>th</sup> Mer.

Section Corner common to Sections

11, 12, 13, and 14

Corner consists of a *Br. cop. iron pipe* (not) in place

State condition *good*

Dimensions above ground *2 x 5"* inches

Sketch grooves, letters, figures, or notches, on proper face or edge.

CARDINAL POSITION

DIAGONAL POSITION



N Top S E

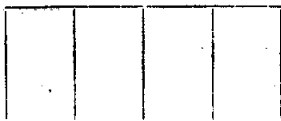

NW SW SE NE

Mound of is located

Pits are located

Sketch markings of Bearing Trees (or Rocks) in proper box and fill blanks below, giving bearings from Corner to Trees and Distances in Links.

Species	<i>J. Pine</i>	<i>J. Pine</i>	<i>J. Pine</i>	<i>J. Pine</i>
Diameter	<i>16"</i>	<i>18"</i>	<i>9"</i>	<i>15"</i>
Bearing	<i>N36°W</i>	<i>N42°E</i>	<i>S33°30'E</i>	<i>S64°15'W</i>
Distance	<i>30</i>	<i>66</i>	<i>28</i>	<i>28</i>

Do you believe this to be a genuine Land Office Corner? *Yes*

If not, why?

*Dorman J. Sutton*  
(Signature)

*11-28-34*  
(Date)

*Com. P. Sutton*  
(Title)

Corner again.

Give any further facts which will aid in finding this

..... chains distant.

from which this Corner bears *N 33° 30' W*

side of *tree*

tree *9* inches diameter, on the *NW*

Metal Location Poster is on *ad. Pine*

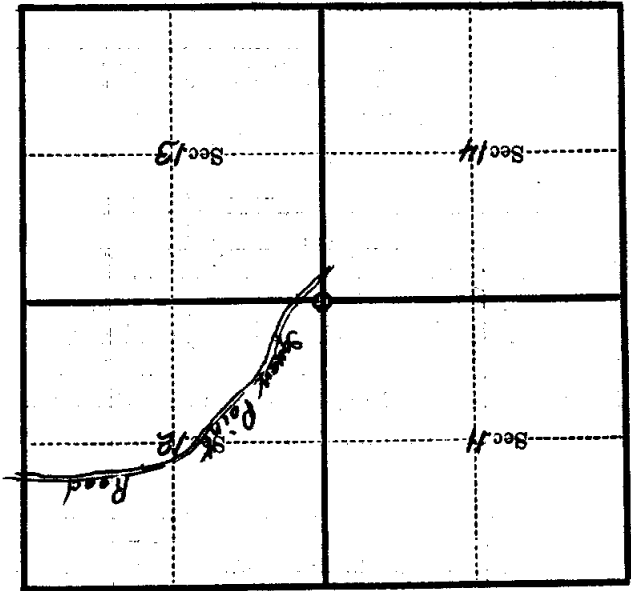

(Make sketch of topography near Corner)

Mer. 5-21

5th

R. 31W

T. 143N