

U. S. Department of Agriculture

FOREST SERVICE

*Posted*

Chippewa NATIONAL FOREST 019

CORNERS OF THE PUBLIC SURVEY

T. 143N. R. 31W 5<sup>th</sup> Mer.

Sixteenth Corner common to Sections

\_\_\_\_\_ and 23

Corner consists of a Brass Caped pipe (~~rod~~) in place

State condition Good

Dimensions above ground 7" inches

Sketch grooves, letters, figures, or notches, on proper face or edge.

CARDINAL POSITION

DIAGONAL POSITION

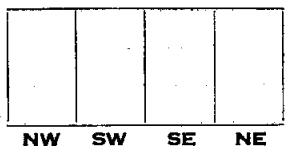
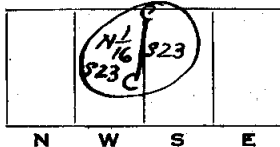

Mound of \_\_\_\_\_ is located \_\_\_\_\_

Pits are located \_\_\_\_\_

Sketch markings of Bearing Trees (or Rocks) in proper box and fill blanks below, giving bearings from Corner to Trees and Distances in Links.

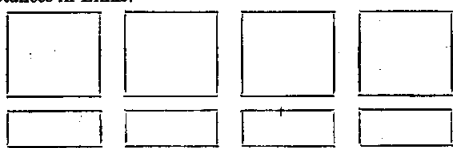

Species P. Oak Aspen

Diameter 6" 6"

Bearing N. 72° W. S 63° E.

115 Distance 8 1/4 21

Do you believe this to be a genuine Land Office Corner? Yes

If not, why? \_\_\_\_\_

J.A. Gjelhaug

(Signature)

Tech. Eng.

(Title)

11/27/34  
(Date)

Corner again.

Give any further facts which will aid in finding this

004 chains distant.

from which this Corner bears N. 39° E.

side of *Tree*

tree 5 inches diameter, on the N.E.

Metal Location Poster is on a *maple*

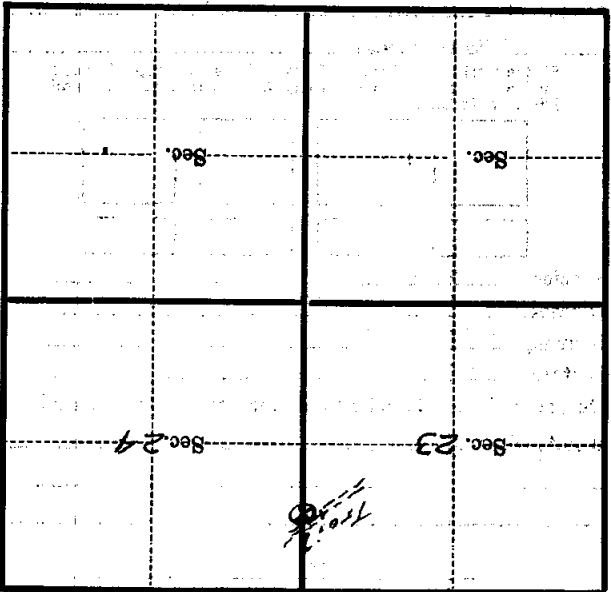

(Make sketch of topography near Corner)

0-21

T. 193N. R. 31W. Mer. 573