

U. S. Department of Agriculture

FOREST SERVICE

Posted

Chippewa NATIONAL FOREST

CORNERS OF THE PUBLIC SURVEY

T. *143N* R. *30W* *5th* Mer.
Sixteenth Corner common to Sections

.....,, *1*, and *6*.....

Corner consists of a *Br cap. iron* (not) in place

State condition *good*

Dimensions above ground *1 x 10* inches

Sketch grooves, letters, figures, or notches, on proper face or edge.

CARDINAL POSITION

DIAGONAL POSITION

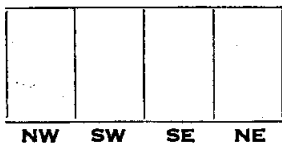
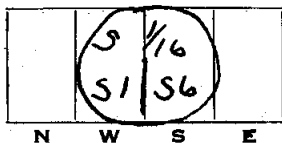

Mound of is located

Pits are located

Sketch markings of Bearing Trees (or Rocks) in proper box and fill blanks below, giving bearings from Corner to Trees and Distances in Links.

<i>S 1/16</i>	<i>S 1/16</i>		
<i>S 6</i>	<i>S 1</i>		
<i>BT</i>	<i>BT</i>		

Species *Tam* *Tam*

Diameter *3"* *4"*

Bearing *S 36° E* *N 84° W*

Distance *15* *45*

Do you believe this to be a genuine Land Office Corner? *Yes*

If not, why?

Dorman J. Sutton

(Signature)

Compassman

(Title)

12-6-34
(Date)

Corner again.

Give any further facts which will aid in finding this

chains distant.

from which this Corner bears ¹⁵ N 36° W

side of tree

tree 3 inches diameter, on the NW corner
Metal Location Poster is on a Jam

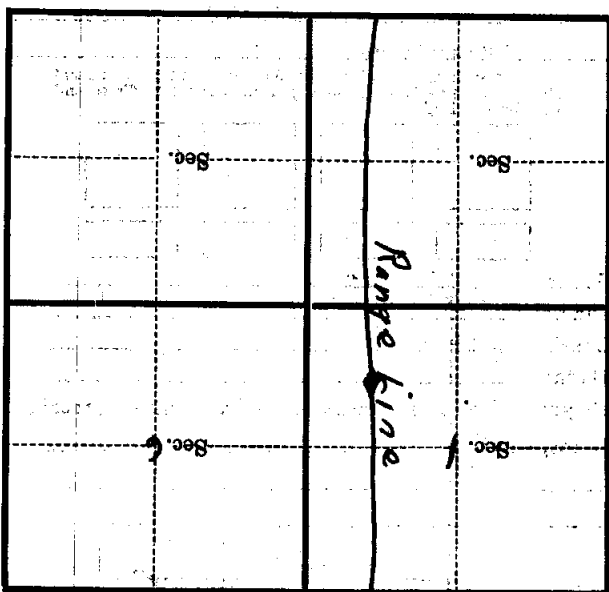

(Make sketch of topography near Corner)

T. 143N R. 30W 5th Mer. D-25