

U. S. Department of Agriculture

FOREST SERVICE

Posted C3

Chippewa NATIONAL FOREST

CORNERS OF THE PUBLIC SURVEY

T. 143N R. 30W 5th Mer.
Quarter Corner common to Sections

6, _____, _____, and _____

Corner consists of a Br. cap. iron pipe (not) in place
State condition good

Dimensions above ground 1x6 inches

Sketch grooves, letters, figures, or notches, on proper face or edge.

CARDINAL POSITION

DIAGONAL POSITION

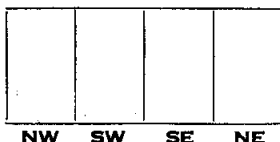
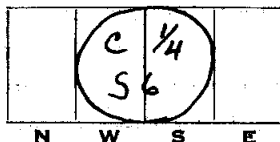

Mound of _____ is located _____

Pits are located _____

Sketch markings of Bearing Trees (or Rocks) in proper box and fill blanks below, giving bearings from Corner to Trees and Distances in Links.

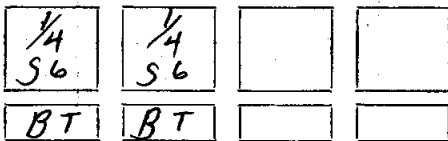

Species W. Oak R. Oak _____

Diameter 10" 8" _____

Bearing N 81° 45' E N 64° W _____

Distance 29 9 _____

Do you believe this to be a genuine Land Office Corner? Yes.

If not, why? _____

Dorman J. Sutton

(Signature)

12-10-34
(Date)Compassman
(Title)

Corner again.

Give any further facts which will aid in finding this

chains distant.

09

from which this Corner bears S 64° E

side of trees

tree 8 inches diameter, on the SE

Metal Location Poster is on a R. Oak

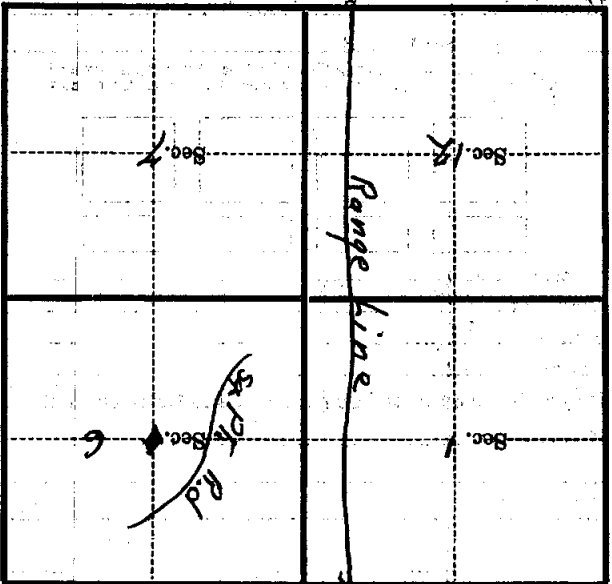

(Make sketch of topography near Corner)

T. 145N R. 30W 5th Mer. C-3