

U. S. Department of Agriculture
FOREST SERVICE

Posted

B 2

Chippewa NATIONAL FOREST

CORNERS OF THE PUBLIC SURVEY

T. *143N* R. *30W* *5th* Mer.
Sixteenth Corner common to Sections
6, _____, _____, and _____

Corner consists of a *Br cap. pipe* (not) in place
State condition *good*

Dimensions above ground *125* inches

Sketch grooves, letters, figures, or notches, on proper face or edge.

CARDINAL POSITION

DIAGONAL POSITION

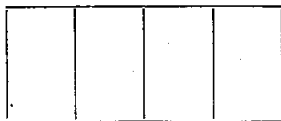
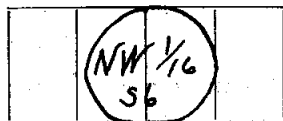

N *Top* S E

NW SW SE NE

Mound of _____ is located _____

Pits are located _____

Sketch markings of Bearing Trees (or Rocks) in proper box and fill blanks below, giving bearings from Corner to Trees and Distances in Links.



Species *Aspen Aspen*
Diameter *10 12"*
Bearing *N79°E N26°45W*
Distance *21 24*

Do you believe this to be a genuine Land Office Corner? *yes.*
If not, why? _____

Darman J. Sutton

(Signature)

12-3-34
(Date)

Compassman
(Title)

Corner again.

Give any further facts which will aid in finding this

chains distant.

21

from which this Corner bears S 79° W

side of tree

Metal Location Poster is on an Aspen tree 10 inches diameter, on the SW

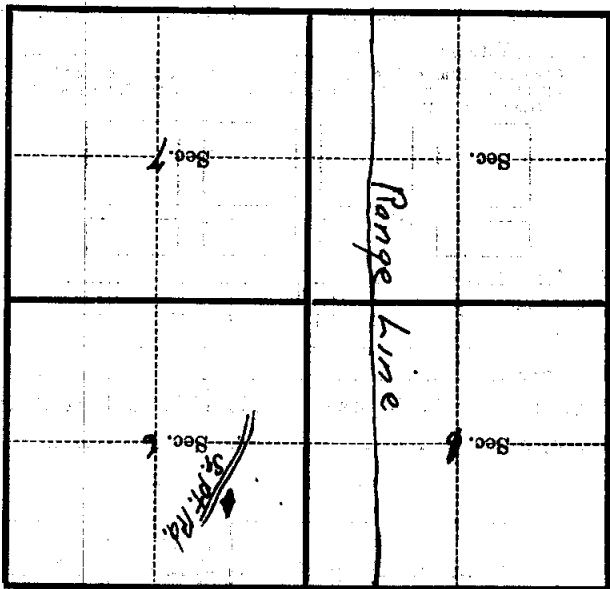

(Make sketch of topography near Corner)

T. 143 N R. 50 W 5th B-2 Mer.