

U. S. Department of Agriculture
FOREST SERVICE

----- NATIONAL FOREST

CORNERS OF THE PUBLIC SURVEY

T. 143 R. 29 5th Mer.

14 Corner common to Sections
25, _____, _____, and 26

Corner consists of a Iron Pipe (~~not~~) in place
State condition Good

Dimensions above ground _____ inches

Sketch grooves, letters, figures, or notches, on proper face or edge.

CARDINAL POSITION

DIAGONAL POSITION

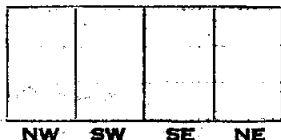
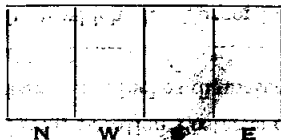

Mound of _____ is located _____

Pits are located _____

Sketch markings of Bearing Trees (or Rocks) in proper box and fill blanks below, giving bearings from Corner to Trees and Distances in Links.

Species _____

Diameter _____

Bearing _____

Distance _____

Do you believe this to be a genuine Land Office Corner? yes

If not, why? _____

4/3/59
(Date)

S. M. Norman
(Signature)

Asst. Dist. Engr.
(Title)

Lined writing area with horizontal dashed lines.

Blue line marker N from corner
Corner again.

Give any further facts which will aid in finding this
73 line chains distant.

From which this Corner bears
West
side of

5 inches diameter, on the *West*
Metal Location Poster is on a *post*

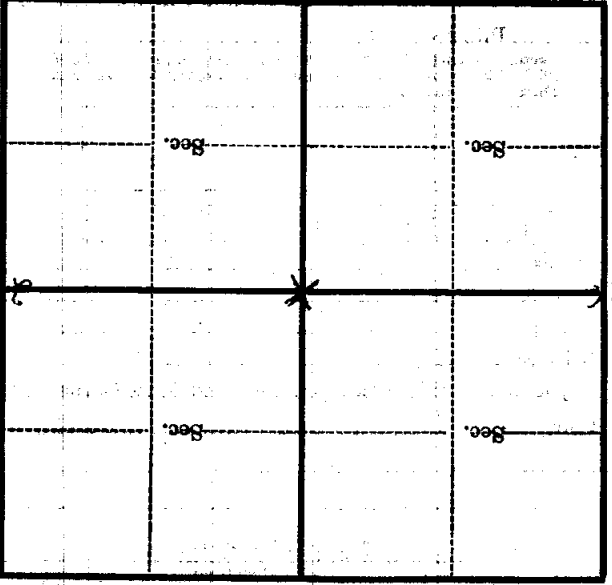

(Make sketch of topography near Corner)

U. S. Department of Agriculture
FOREST SERVICE

P.

Chippewa NATIONAL FOREST

CORNERS OF THE PUBLIC SURVEY

T. *143N* R. *29W* *5* Mer.

1/4 Corner common to Sections

26, 25, and

Corner consists of a *iron nail* (not) in place

State condition *good*

Dimensions above ground *178* inches

Sketch grooves, letters, figures, or notches, on proper face or edge.

CARDINAL POSITION

DIAGONAL POSITION

<i>1/4</i>	<i>9</i>		<i>9</i>
	<i>26</i>		<i>25</i>

N W S E NW SW SE NE

Mound of _____ is located _____

Pits are located _____

Sketch markings of Bearing Trees (or Rocks) in proper box and fill blanks below, giving bearings from Corner to Trees and Distances in Links.

	<i>None</i>		

Species _____

Diameter _____

Bearing _____

Distance _____

Do you believe this to be a genuine Land Office Corner? *Yes*

If not, why? _____

Robert L. ...
Estimate

4/8/35
(Date)

(Title)

Section 2
Traverse

Corner again.

Give any further facts which will aid in finding this

~~obvious distance.~~

from which this Corner bears

side of

tree ⁴ inches diameter, on the

Metal Location Poster is on a

Section 2
Section 6

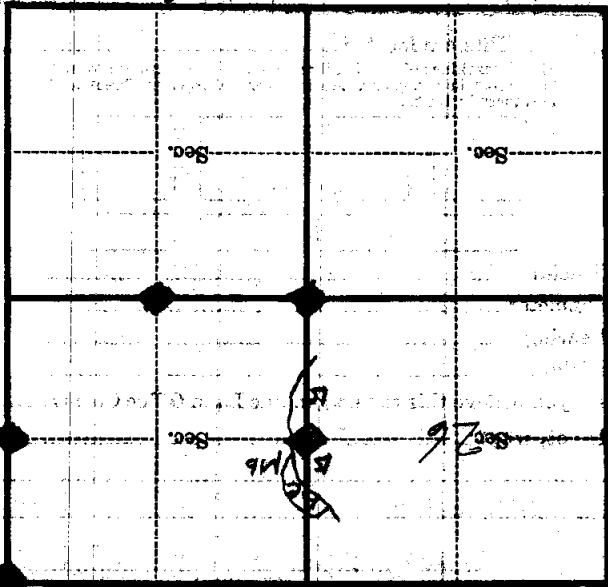

(Make sketch of topography near Corner)

T. 143N R. 29W 5
Mer. 17421