

Form 874-B—Revised May, 1918  
U. S. Department of Agriculture  
FOREST SERVICE

X-6-7

CHIPPEWA NATIONAL FOREST

CORNERS OF THE PUBLIC SURVEY

T. 142 N R. 27 W Mer. 5

9 1/16 Corner common to Sections  
NW 1/4 & SW 1/4 MC., and Sec. 32

Corner consists of a Wooden post in place

State condition Fair

Dimensions above ground 4' 6" inches

Sketch grooves, letters, figures, or notches, on proper face or edge.

CARDINAL POSITION

DIAGONAL POSITION

		1/16	
		S 32	
N	W	S	E

NW	SW	SE	NE

Mound of \_\_\_\_\_ is located \_\_\_\_\_

Pits are located \_\_\_\_\_

Sketch markings of Bearing Trees (or Rocks) in proper box and fill blanks below, giving bearings from Corner to Trees and Distances in Links.

Species \_\_\_\_\_

Diameter \_\_\_\_\_

Bearing \_\_\_\_\_

Distance \_\_\_\_\_

Do you believe this to be a genuine Land Office Corner? Yes

If not, why? \_\_\_\_\_

R.M. Pierrelie

(Signature)

Estimator

(Title)

3/25/35

(Date)

X-6-7

Corner again.  
N of telephone line I chain close  
to take there.

Give any further facts which will aid in finding the  
chain distant.  
From which this Corner bears  
side of  
tree inches diameter, on the  
Metal Location Poster is on a corner

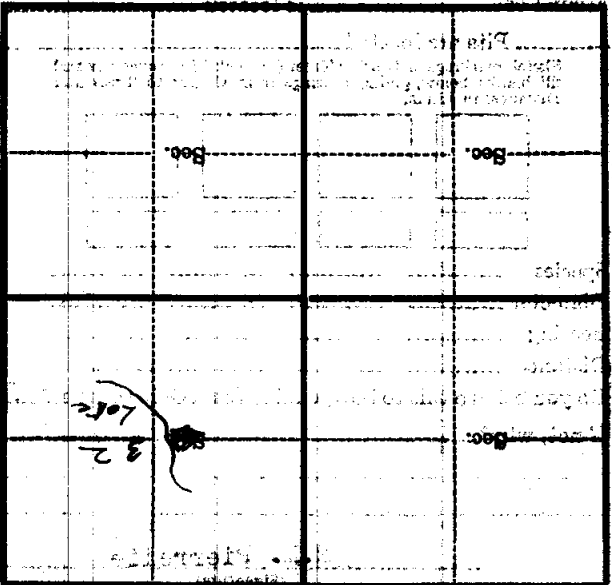

(Make sketch of topography near Corner)