

X-5

U. S. Department of Agriculture

FOREST SERVICE

X-5

P.

~~Chippewa~~ NATIONAL FOREST  
CORNERS OF THE PUBLIC SURVEY

T. 142N R. 27W 5P Mer.

1/4 Corner common to Sections  
31, 32, and \_\_\_\_\_

Corner consists of a Iron post (not) in place  
State condition Good

Dimensions above ground 18" inches  
Sketch grooves, letters, figures, or notches, on proper face or edge.

CARDINAL POSITION

DIAGONAL POSITION

U. S. General Land Office Survey							
	<u>31</u>	<u>32</u>					
N	W	S	E	NW	SW	SE	NE

Mound of \_\_\_\_\_ is located \_\_\_\_\_

Pits are located \_\_\_\_\_

Sketch markings of Bearing Trees (or Rocks) in proper box and fill blanks below, giving bearings from Corner to Trees and Distances in Links.

<u>1/4</u> <u>590</u> <u>31</u>	<u>1/4</u> <u>Sec. 32</u>	<u>1/4</u> <u>Sec. 31</u>	<u>1/4</u> <u>Sec. 32</u>
<u>BT</u>	<u>BT</u>	<u>BT</u>	<u>BT</u>

Species	<u>Tapp.</u>	<u>C. Spruce</u>	<u>C. Spruce</u>	<u>Cedar Elm</u>
Diameter	<u>17</u>	<u>10</u>	<u>8"</u>	<u>12"</u>
Bearing	<u>N 15° W</u>	<u>N 32° W</u>	<u>S 45° W</u>	<u>S 43° W</u>
Distance	<u>.19</u>	<u>.07</u>	<u>.19</u>	<u>.18</u>

Do you believe this to be a genuine Land Office Corner? Yes

If not, why? \_\_\_\_\_

R. M. Purcell  
3/25/35 (Date) Estimator (Title)

X-5

*Along trail*

Corner again.

Give any further facts which will aid in finding this

chains distant.

07

from which this Corner bears *55°W*

side of *tree*

tree 16 inches diameter, on the *SW*

Model Location Poster is on a *Block*

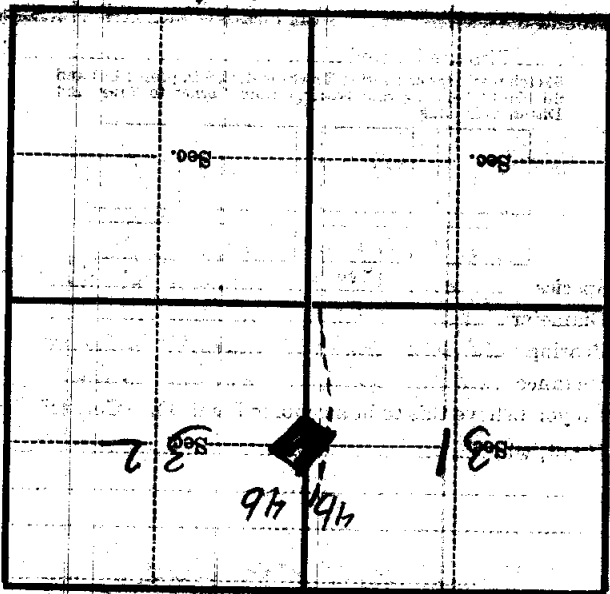

(Make sketch of topography near Corner)

T. L. H. N. R. 926  
Merr.

Form 871-9—Revised May, 1915  
 U. S. Department of Agriculture  
 FOREST SERVICE

X-5

Chippewa NATIONAL FOREST

CORNERS OF THE PUBLIC SURVEY

T. 142 N. R. 27 W. S. 5

1/4 Corner common to Sections 31, 32, and

Corner consists of a IRON Post (not) in good State condition Good

Dimensions above ground 18" inches

Sketch grooves, letters, figures, or notches, on proper face or edge

CARDINAL POSITION

DIAGONAL POSITION

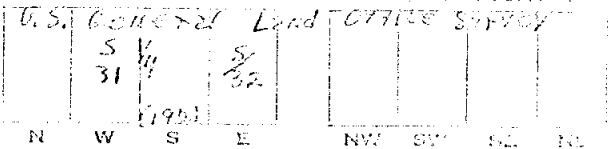

Mound of is located

Pits are located

Sketch markings of Bearing Trees (or Posts) in proper bearings and fill blanks below, giving bearings from Corner to Trees and Distances in Links.



Species 120 C. TRAC C. S. 100 200  
 Diameter 14 10 8 12  
 Bearing N150W N30SE S45W S45E  
 Distance .19 .07 .19 .18

Do you believe this to be a genuine Land Office Corner?

Why?

R. M. P. 11/15

Blaine Trail

Corner again.

Give any further facts which will aid in finding this

07 chairs distant.

from which this corner bears S 58° W

side of Twp 2

tree 16 inches diameter, on the SW

Next location Post is on a Cedar

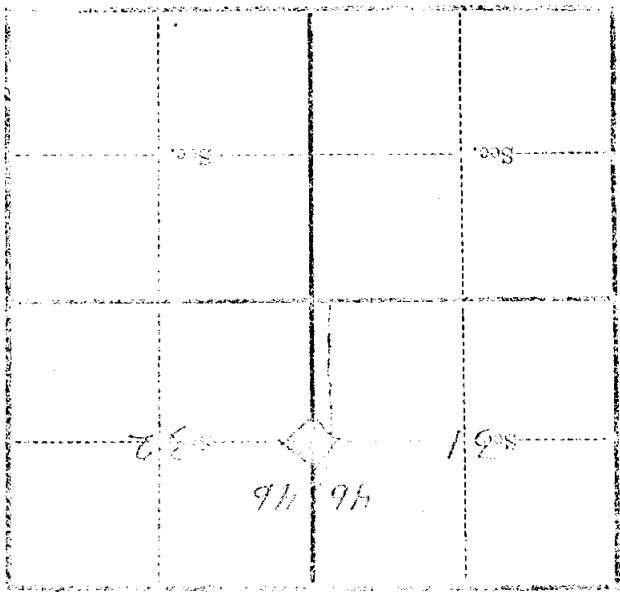

X-5