

U. S. Department of Agriculture
FOREST SERVICE

X-15

CHIPPENAW NATIONAL FOREST

CORNERS OF THE PUBLIC SURVEY

T. 143 R. 26 S Mer.

C 1/4 Corner common to Sections

34, and

Corner consists of a stake in place

State condition fair

Dimensions above ground 12' pole inches

Sketch grooves, letters, figures, or notches, on proper face or edge.

CARDINAL POSITION

DIAGONAL POSITION

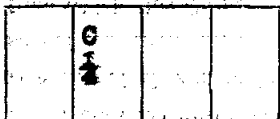

N W S E

NW SW SE NE

Mound of is located

Pits are located

Sketch markings of Bearing Trees (or Rocks) in proper box and fill blanks below, giving bearings from Corner to Trees and Distances in Links.



Species

Diameter

Bearing

Distance

Do you believe this to be a genuine Land Office Corner? No.

If not, why? County Corner

Raymond T. DeFaut

RAYMOND T. DEFANT

(Signature)

Jr. Civil Engineer

(Title)

3-15-40

(Date)

Corner is 50 ft. East of center
line of road.

Corner again.

Give any further facts which will aid in finding this

chain element:

from which this corner bears at corner

tree inches diameter, on the

Metal Location Post is on a

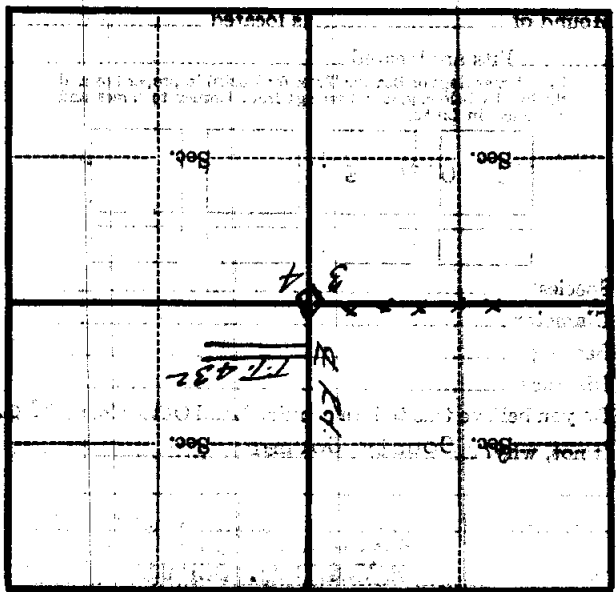

(Makes sketch of topography near corner)