

U. S. Department of Agriculture
FOREST SERVICE

P.
N-13

Chip Purchase NATIONAL FOREST

CORNERS OF THE PUBLIC SURVEY

T. 143 R. 26 522 Mer.

Section 17 Corner common to Sections
15, 16, 21, and 22

Corner consists of a Iron Pipe in place
State condition Good

Dimensions above ground 12" inches

Sketch grooves, letters, figures, or notches, on proper face or edge.

CARDINAL POSITION

DIAGONAL POSITION

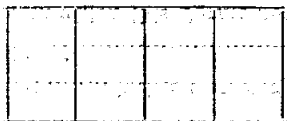

N W S E

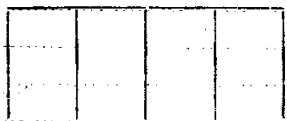

NW SW SE NE

Mound of _____ is located _____

Pits are located _____

Sketch markings of Bearing Trees (or Rocks) in proper box and fill blanks below, giving bearings from Corner to Trees and Distances in Links.

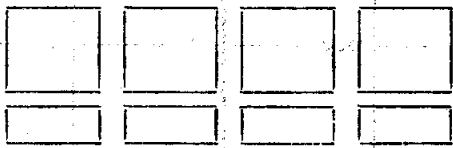

Species _____

Diameter _____

Bearing _____

Distance _____

Do you believe this to be a genuine Land Office Corner? Yes

If not, why? _____

O. H. Pearson
(Signature)
Feb 28, 35
(Date)
Forester
(Title)

Dotted lines for writing notes.

Corner again:

Give any further facts which will aid in finding this

chains distant.

from which this Corner bears

side of *COUNTY ROAD*

8" inches diameter, on the

South

Metal Location Poster is on a

Telephone Post

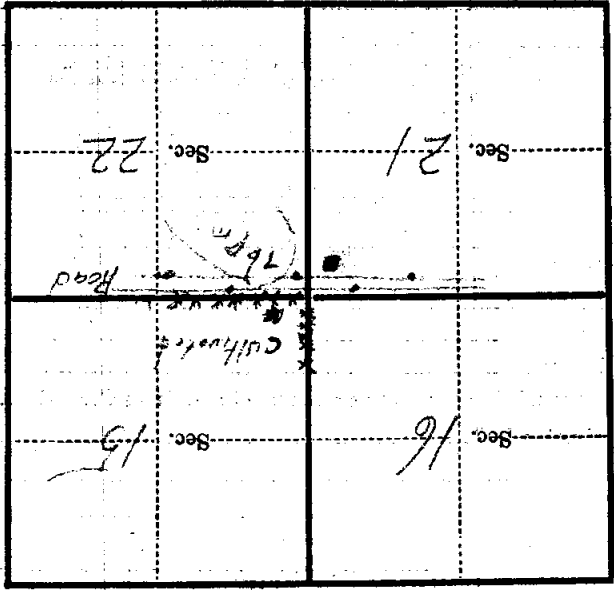

(Make sketch of topography near Corner)

T. 143 R. 21 Mer. 4th

U. S. Department of Agriculture

FOREST SERVICE

CHIPPENAW NATIONAL FOREST

N-13

CORNERS OF THE PUBLIC SURVEY

T. 143 R. 26 5 Mer.

Section. Corner common to Sections

16, 15, 21, and 22

Corner consists of a brass pipe in place

State condition Very good

Dimensions above ground 6 inches

Sketch grooves, letters, figures, or notches, on proper face or edge.

CARDINAL POSITION

DIAGONAL POSITION

Cardinal position diagram with four empty boxes for N, W, S, E.

N W S E

Diagonal position diagram with four empty boxes for NW, SW, SE, NE.

NW SW SE NE

Mound of is located

Pits are located

Sketch markings of Bearing Trees (or Rocks) in proper box and fill blanks below, giving bearings from Corner to Trees and Distances in Links.

Diagram for sketching bearing trees with two rows of four empty boxes each.

Species

Diameter

Bearing

Distance

Do you believe this to be a genuine Land Office Corner? Yes

If not, why?

Handwritten signature of Raymond T. DeFant

Raymond T. DeFant

(Signature)

Jr. Civil Engineer

(Title)

2-9-40

(Date)

Metal Location Poster is on a Telephone pole
 12" inches diameter, on the South
 side of Telephone pole
 from which this Corner bears North
 chain distant
 Give any further facts which will aid in finding this
 Corner again.
 Corners of section road - approximately 33 ft. North of center
 line of road.

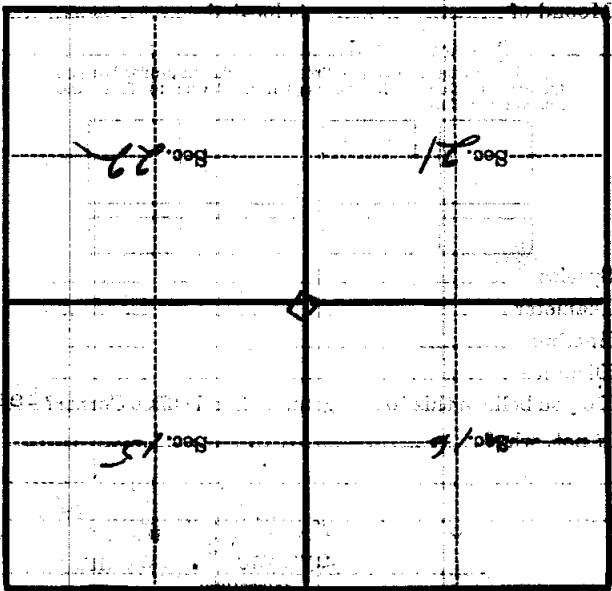

(Make sketch of topography near Corner)