

Form 874-0—Revised May, 1918
 U. S. Department of Agriculture
 FOREST SERVICE

B-21

CHIPPEWA NATIONAL FOREST

CORNERS OF THE PUBLIC SURVEY

T. 142 N R. 31 W 5th Mer.
 N 1/4 Corner common to Sections

1, and 2
 Corner consists of a 1" IRON PIPE & CAP (not) in place
 State condition GOOD

Dimensions above ground 6 inches
 Sketch grooves, letters, figures, or notches, on proper face or edge.
 CARDINAL POSITION DIAGONAL POSITION

				142-31 52 7/31				
N	W	S	E	NW	SW	SE	NE	

Mound of _____ is located _____

Pits are located _____

Sketch markings of Bearing Trees (or Rocks) in proper box and fill blanks below, giving bearings from Corner to Trees and Distances in Links.

Species _____

Diameter _____

Bearing _____

Distance _____

Do you believe this to be a genuine Land Office Corner? YES

If not, why? _____

Arthur J. Johnson
 (Signature)
 State Field Worker
 (Title)

11/11/37
 (Date)

Corner again.

Give any further facts which will aid in finding this

chains distant.

from which this Corner bears

side of

tree inches diameter, on the

Metal Location Poster is on a

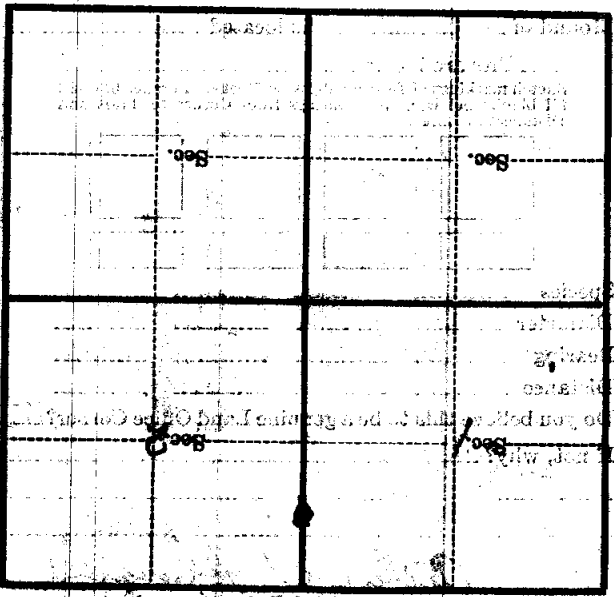

(Make sketch of topography near Corner)

T. 142 N. R. 21 W. Sec. 27
Mer. B-21

U. S. Department of Agriculture
FOREST SERVICE

Wja

CHIPPEWA NATIONAL FOREST

B-21

CORNERS OF THE PUBLIC SURVEY

T. *42 N* R. *21 W* *3rd* Mer.

N 1/2 Corner common to Sections
1, and *2*

Corner consists of a *IRON PIPE & CAP* (not) in place
State condition *GOOD*

Dimensions above ground *6* inches
Sketch grooves, letters, figures, or notches, on proper face or edge.

CARDINAL POSITION				DIAGONAL POSITION			
N	W	S	E	NW	SW	SE	NE
			<div style="border: 1px solid black; border-radius: 50%; padding: 5px; display: inline-block;"> <i>42-31</i> <i>32+31</i> </div>				

Mound of _____ is located _____

Pits are located _____

Sketch markings of Bearing Trees (or Rocks) in proper box and fill blanks below, giving bearings from Corner to Trees and Distances in Links.

Species _____
Diameter _____
Bearing _____
Distance _____

Do you believe this to be a genuine Land Office Corner? *YES*

If not, why? _____

Arthur J. Johnson

(Signature)

11/14/37
(Date)

Samuel Skilled Worker

(Title)

Corner again.

Give any further facts which will aid in finding this

chains distant.

from which this Corner bears

side of

tree inches diameter, on the

Metal Location Poster is on a

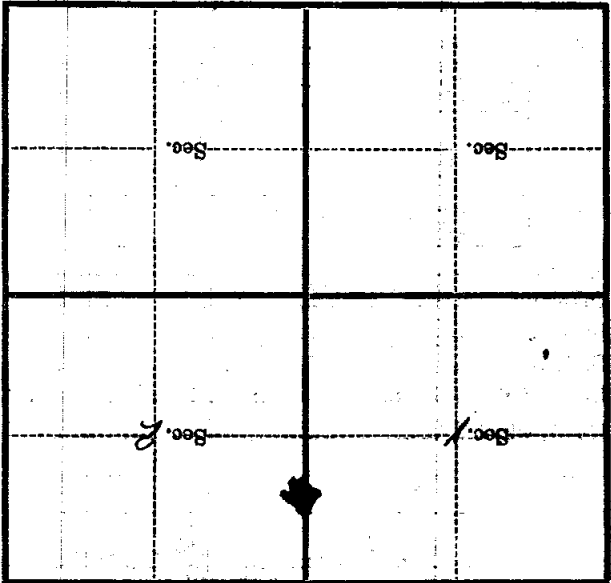

(Make sketch of topography near Corner)

8-21

Mer.

5-28

R. 31W

T. 142N