

U. S. Department of Agriculture
FOREST SERVICE

Chippewa NATIONAL FOREST

CORNERS OF THE PUBLIC SURVEY

T. 14R N R. 31W 5th Mer.

C. E. 46
29 Corner common to Sections
29, _____, _____, and _____

Corner consists of a Cap iron pipe (not) in place
State condition good

Dimensions above ground 2 1/2 x 1 1/4 inches
Sketch grooves, letters, figures, or notches, on proper face or edge.

CARDINAL POSITION

DIAGONAL POSITION

	None		
--	------	--	--

--	--	--	--

N W S E

NW SW SE NE

Mound of _____ is located _____

Pits are located _____

Sketch markings of Bearing Trees (or Rocks) in proper box and fill blanks below, giving bearings from Corner to Trees and Distances in Links.

Species None

Diameter _____

Bearing _____

Distance _____

Do you believe this to be a genuine Land Office Corner? _____

If not, why? _____

County Resurvey

Dorman J. Sutton

(Signature)

Engineer

(Title)

3-18-35

(Date)

Corner again.

Give any further facts which will aid in finding this chains distant.

from which this Corner bears

side of

tree inches diameter, on the

Metal Location Poster is on a *Nine*

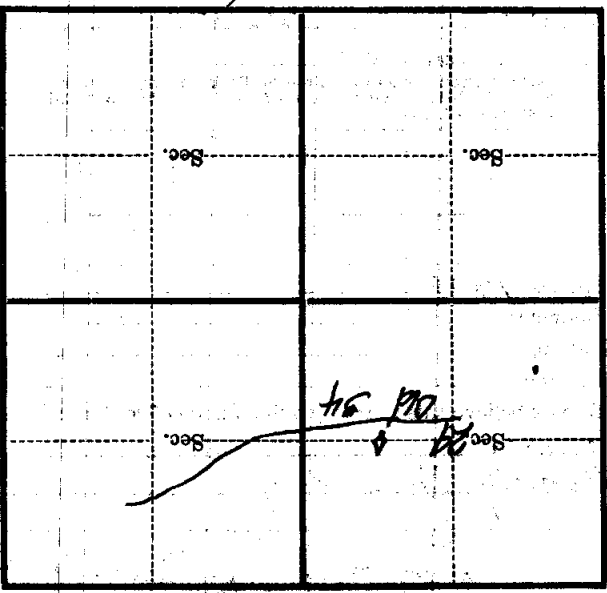

(Make sketch of topography near Corner)

T. 142N R. 51W 5th Mer. 1-8