

U. S. Department of Agriculture
FOREST SERVICE

122
27-37
C.B.
X-1
D

Chippewa NATIONAL FOREST

CORNERS OF THE PUBLIC SURVEY

T. *142 N* R. *31 W* Mer. *5-10*

Corner common to Sections

31, and (*536-T142-R32*)

Corner consists of a *2" I.P.* (not) in place

State condition *Good*

Dimensions above ground *15* inches

Sketch grooves, letters, figures, or notches, on proper face or edge.

CARDINAL POSITION

DIAGONAL POSITION

N W S E

NW SW SE NE

Mound of _____ is located _____

Pits are located _____

Sketch markings of Bearing Trees (or Rocks) in proper box and fill blanks below, giving bearings from Corner to Trees and Distances in Links.

Species _____

Diameter _____

Bearing *var* _____

Distance _____

Do you believe this to be a genuine Land Office Corner? *No*

If not, why? *County Corner*

Carl E. Headland

(Signature) *Foreman*

4/28/27
(Date)

(Title) *F-48*

Corner again.

Give any further facts which will aid in finding this

chain's distant.

0.30

from which this Corner bears

N 15 W

side of

tree inches diameter, on the

Metal Location Poster is on a

White Pine

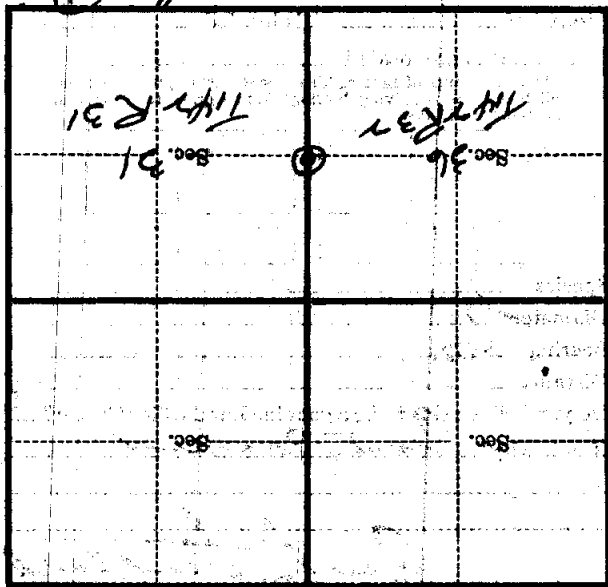

(Make sketch of topography near Corner)

Met.

R

T

X-1

U. S. Department of Agriculture
FOREST SERVICE

Chippewa

NATIONAL FOREST

X-1
23
202

CORNERS OF THE PUBLIC SURVEY

T. *142N* R. *31W* Mer.

Corner common to Sections

31, and (*S36-142-32*)

Corner consists of a *2" F.P.* (not) in place

State condition *Good*

Dimensions above ground *15* inches

Sketch grooves, letters, figures, or notches, on proper face or edge.

CARDINAL POSITION

DIAGONAL POSITION

--	--	--	--

--	--	--	--

N W S E

NW SW SE NE

Mound of _____ is located _____

Pits are located _____

Sketch markings of Bearing Trees (or Rocks) in proper box and fill blanks below, giving bearings from Corner to Trees and Distances in Links.

Species *None*

Diameter _____

Bearing _____

Distance _____

Do you believe this to be a genuine Land Office Corner? *No*

If not, why? *County corner*

Carl H. Steadman
(Signature)

Apr 18/27
(Date)

Memorandum 1748
(Title)

Corner again.

Give any further facts which will aid in finding this

chains distant.

0.20

from which this Corner bears

N 55 W

side of

tree inches diameter, on the

Metal Location Poster is on a

White Pine

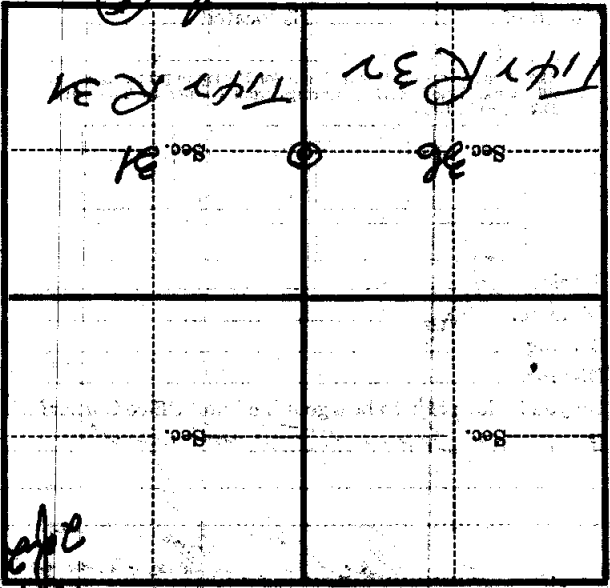

(Make sketch of topography near Corner)

T 142 N R 31 W 54 Mer

U. S. Department of Agriculture

FOREST SERVICE

Chipewewa NATIONAL FOREST

CORNERS OF THE PUBLIC SURVEY

T. 142 R. 31 + 32 5 Mer. Quarter Corner common to Sections

31 and 36 Corner consists of a 2" iron pipe in place

State condition good

Dimensions above ground 14 inches

Sketch grooves, letters, figures, or notches, on proper face or edge.

CARDINAL POSITION

DIAGONAL POSITION

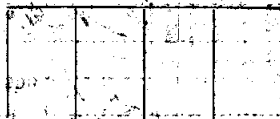
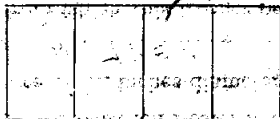

N

W

S

E

NW

SW

SE

NE

Mound of is located

Pits are located

Sketch markings of Bearing Trees (or Rocks) in proper box and fill blanks below, giving bearings from Corner to Trees and Distances in Links.



Species W Pine

Diameter 20

Bearing S 15° E

Distance 30.1k

Do you believe this to be a genuine Land Office Corner? No

If not, why? County reserve

D. J. Sutton

(Signature)

10/22/35 (Date)

Field Asst. (Title)

Station 10

Section 36

Section 36

Section 36

Section 36

Section 36

Section 36

Section 36

Corner again.

Give any further facts which will aid in finding this

chain distance

from which this Corner bears

N 15° W

side of tree

tree 80 inches diameter, on the NW

Metal Location Poster is on a WP 3/4

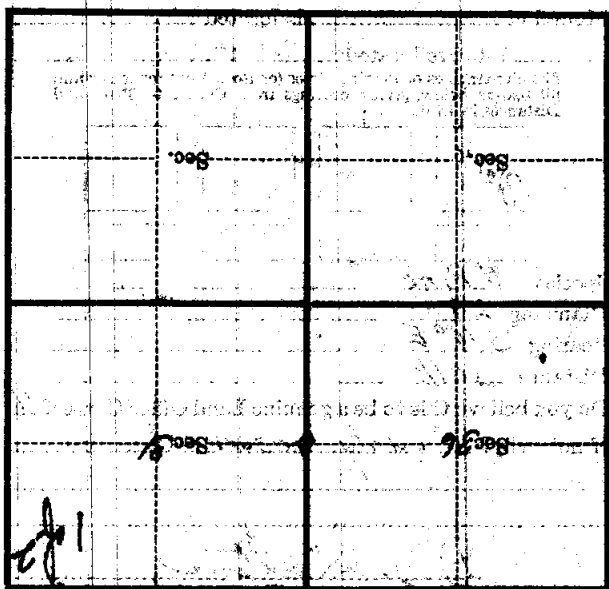

(Make sketch of topography near Corner)

10/22

X-1

Mer

R 3/4 = 32

T 1/4