

Form 874-B—Revised May, 1918
 U. S. Department of Agriculture
 FOREST SERVICE

173
 7-28-37
 5-13

Chippewa NATIONAL FOREST
 CORNERS OF THE PUBLIC SURVEY

T. *142N* R. *30W* S. *5* Mer.
 N¹⁶ Corner common to Sections

27, and 28
 Corner consists of a *1" I.P.W. cap* (not) in place
 State condition *Good*

Dimensions above ground *6* inches
 Sketch grooves, letters, figures, or notches, on proper face or edge.

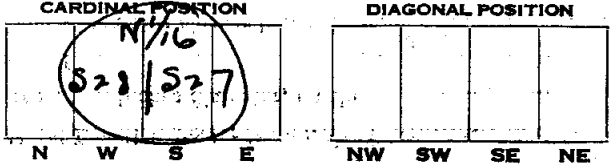

Mound of _____ is located _____

Pits are located _____

Sketch markings of Bearing Trees (or Rocks) in proper box and fill blanks below, giving bearings from Corner to Trees and Distances in Links.

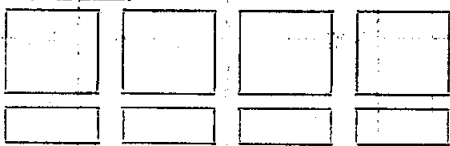

Species _____
 Diameter _____
 Bearing _____
 Distance _____

Do you believe this to be a genuine Land Office Corner? *Yes*

If not, why? _____

R. Moore
 (Signature)
Asst Dir - F48
 (Title)

1/17/37
 (Date)

U. S. Department of Agriculture

FOREST SERVICE

NATIONAL FOREST

CORNER OF THE PUBLIC LANDS

Corner again.

Give any further facts which will aid in finding this

chain distant.

From which this Corner bears

859 W

side of

tree inches diameter, on the

Metal Location Poster is on a *Corner*

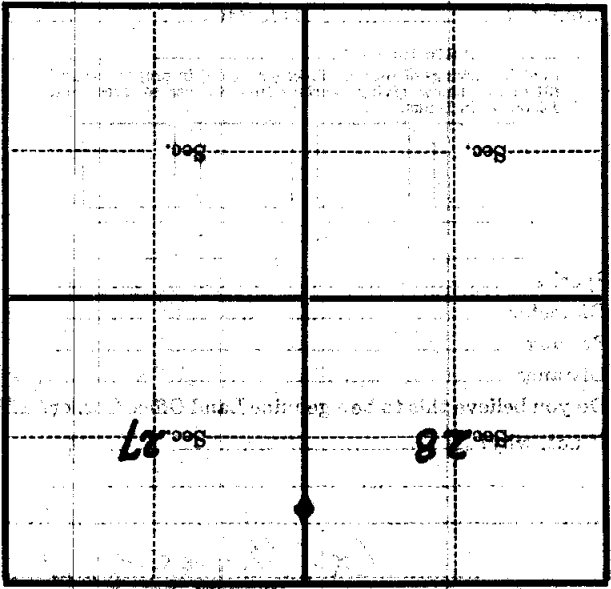

(Make sketch of topography near Corner)

Mer. S-13

4th

W 7 N R 30 W

T

U. S. Department of Agriculture

FOREST SERVICE

5-13

already posted

Chippewa NATIONAL FOREST

CORNERS OF THE PUBLIC SURVEY

T. 142 R. 30 5th Mer.

N 1/16 Corner common to Sections

27, and 28

Corner consists of a 1" I.P. w/cap (not) in place

State condition good

Dimensions above ground 6 inches

Sketch grooves, letters, figures, or notches, on proper face or edge.

CARDINAL POSITION

DIAGONAL POSITION

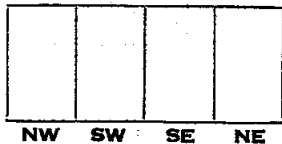
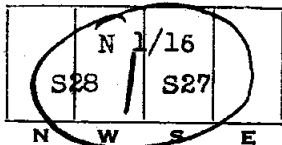

Mound of is located

Pits are located

Sketch markings of Bearing Trees (or Rocks) in proper box and fill blanks below, giving bearings from Corner to Trees and Distances in Links.

Species

Diameter

Bearing

Distance

Do you believe this to be a genuine Land Office Corner? Yes

If not, why?

R. Moore

(Signature)

1/12/37 (Date)

Asst. Ldr. F-48 (Title)

Corner again.

Give any further facts which will aid in finding this

chains distant. 0.08

from which this Corner bears S 59 W

side of

tree $\frac{4}{4}$ inches diameter, on the

Metal Location Poster is on a Tamarack

	Sec.		Sec.
	Sec.		Sec.

(Make sketch of topography near Corner)

Mer. 5-13

5th

30

R.

1st

T.