

U. S. Department of Agriculture  
FOREST SERVICE

U-12

*Chippewa* NATIONAL FOREST

CORNERS OF THE PUBLIC SURVEY

T. *142N* R. *30W* *5th* Mer.

*SE 1/4* Corner common to Sections  
*28*, \_\_\_\_\_, and \_\_\_\_\_

Corner consists of a *4" copper post* (not) in place  
State condition *Set*

Dimensions above ground *36* inches

Sketch grooves, letters, figures, or notches, on proper face or edge.

CARDINAL POSITION

DIAGONAL POSITION

N	W	S	E

NW	SW	SE	NE

Mound of \_\_\_\_\_ is located \_\_\_\_\_

Pits are located \_\_\_\_\_

Sketch markings of Bearing Trees (or Rocks) in proper box and fill blanks below, giving bearings from Corner to Trees and Distances in Links.

Species \_\_\_\_\_

Diameter *None* \_\_\_\_\_

Bearing *None* \_\_\_\_\_

Distance \_\_\_\_\_

Do you believe this to be a genuine Land Office Corner? *No*

If not, why? \_\_\_\_\_

*Established by CCC crew*

*R. Moore*

(Signature)

*Asst. Dir. F.S.*

(Title)

*1/11/37*  
(Date)

U. S. DEPARTMENT OF AGRICULTURE

FOREST SERVICE

COMMISSION ON THE PUBLIC SURVEY

REPORT OF THE COMMISSION

Corner again.

Give any further facts which will aid in finding this

0.15 chains distant.

from which this Corner bears *89 E*

side of

tree inches diameter, on the

*Clear* Metal Station Poster is on a

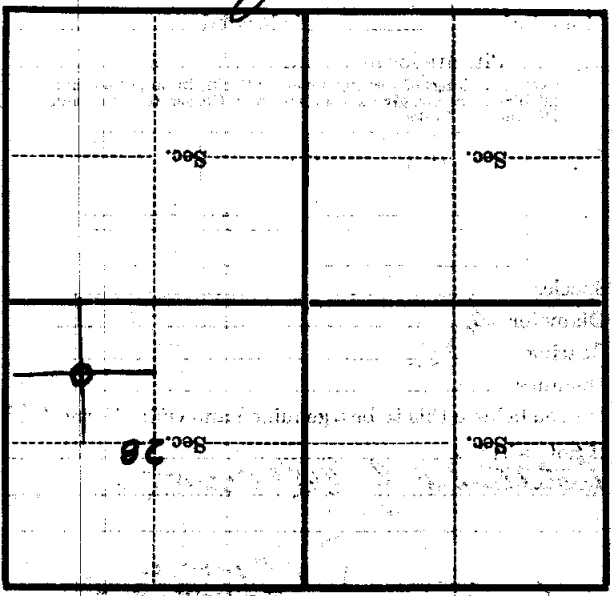

(Make sketch of topography near Corner)

T. W. R. 30 W. 5th Mer. U-12

U. S. Department of Agriculture  
FOREST SERVICE

172  
7-21-37  
OES

*Chippawa* NATIONAL FOREST

4-12

CORNERS OF THE PUBLIC SURVEY

T. 14 <sup>7</sup>/<sub>N</sub>. R. 30 <sup>W</sup>/<sub>5<sup>th</sup></sub> Mer.

*SE 1/6* Corner common to Sections  
*78*, and

Corner consists of a *4" paper post* (not) in place  
State condition *Good*

Dimensions above ground *36* inches

Sketch grooves, letters, figures, or notches, on proper face or edge.

CARDINAL POSITION

DIAGONAL POSITION

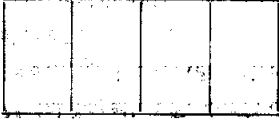

N W S E



NW SW SE NE

Mound of \_\_\_\_\_ is located \_\_\_\_\_

Pits are located \_\_\_\_\_

Sketch markings of Bearing Trees (or Rocks) in proper box and fill blanks below, giving bearings from Corner to Trees and Distances in Links.



Species \_\_\_\_\_  
Diameter *None* \_\_\_\_\_  
Bearing *None* \_\_\_\_\_  
Distance \_\_\_\_\_

Do you believe this to be a genuine Land Office Corner? *No*

If not, why?  
*Established by CCC crew*

*1/11/37* (Date) *R. Moore et al* (Title)  
*Asst. Dir. - FWS*

24

Corner again.  
 Give any further facts which will aid in finding this  
 chain distant.  
 from which this Corner bears  
 side of  
 tree inches diameter, on the  
 Metal Location Poster is on a

*0.15*

*0.95*

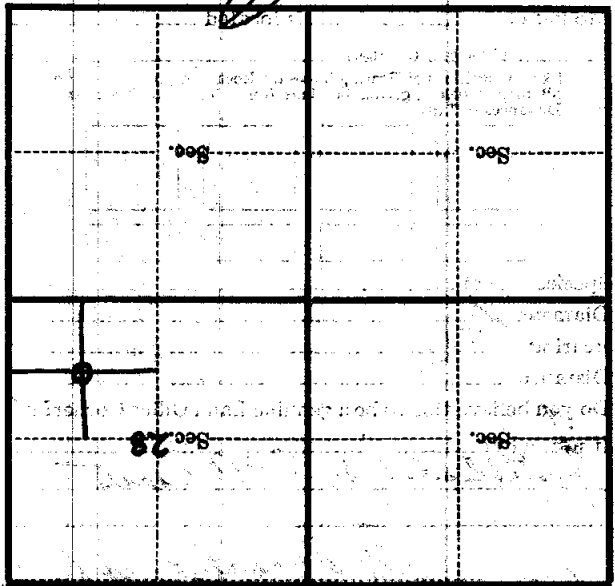

(Make sketch of topography near Corner)

Mer.

*57*

*T. 142N R. 30W*