

U. S. Department of Agriculture
FOREST SERVICE

172
77229
R

0-21

Chippewa NATIONAL FOREST

CORNERS OF THE PUBLIC SURVEY

T. 142N R. 29W 5-12 Mer.

N 1/2 Corner common to Sections
23, 24, _____, and _____

Corner consists of a G.L.O. Monument (~~stone~~) in place
State condition Excellent

Dimensions above ground 6" inches

Sketch grooves, letters, figures, or notches, on proper face or edge.

CARDINAL POSITION

DIAGONAL POSITION

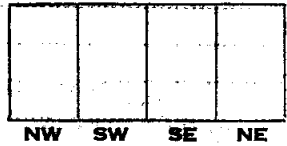
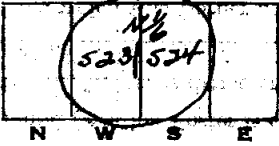

Mound of _____ is located _____

Pits are located _____

Sketch markings of Bearing Trees (or Rocks) in proper box and fill blanks below, giving bearings from Corner to Trees and Distances in Links.



Species _____

Diameter _____

Bearing _____

Distance _____

Do you believe this to be a genuine Land Office Corner? X

If not, why? _____

Edward J. Parke

(Signature)

Junior Forester P-1

(Title)

4/13/37
(Date)

SECTION 13
 T. 142N. R. 29W.
 CORNER OF THE
 SECTION 13

Metal Location Post is on a *Original Stake*
 tree inches diameter, on the *West*
 side of *Marquette*
 from which this Corner bears
 chains distant.

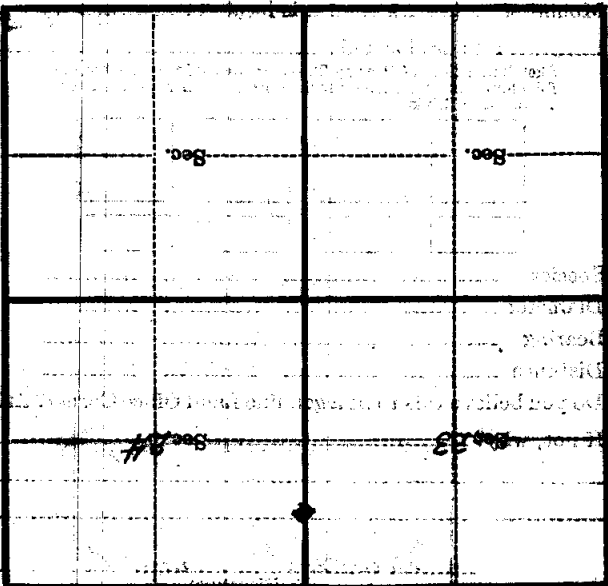

T. 142N. R. 29W. Mer. 1524
 (Make sketch of topography near Corner)
 0-21