

U. S. Department of Agriculture  
FOREST SERVICE

*Posted*  
*X-18*

Chippewa NATIONAL FOREST

CORNERS OF THE PUBLIC SURVEY

T. 142 N. R. 28 W. 5th Mer.

1/4 Corner common to Sections

34 and 35

Corner consists of a Be-capl" pipe (not) in place

State condition good

Dimensions above ground 8" inches

Sketch grooves, letters, figures, or notches, on proper face or edge.

CARDINAL POSITION

DIAGONAL POSITION

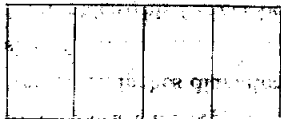

N W S E



NW SW SE NE

Mound of \_\_\_\_\_ is located \_\_\_\_\_

Pits are located \_\_\_\_\_

Sketch markings of Bearing Trees (or Rocks) in proper box and all blanks below, giving bearings from Corner to Trees and Distances in Links.



B.T.



Species Aspen

Diameter 12"

Bearing N20°E

Distance 210.2

Do you believe this to be a genuine Land Office Corner? \_\_\_\_\_

If not, why? \_\_\_\_\_

*Harold Rose Jr.*

(Signature)

Estimator

(Title)

Mar 22 1935

(Date)

COMMERCE OF THE UNITED STATES  
DEPARTMENT OF THE INTERIOR  
BUREAU OF LAND MANAGEMENT

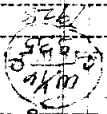

Metal Location Poster is on a *N. 1/4 Sec 36*  
tree inches diameter, on the  
side of  
from which this Corner bears  
Give any further facts which will aid in finding this  
Corner again

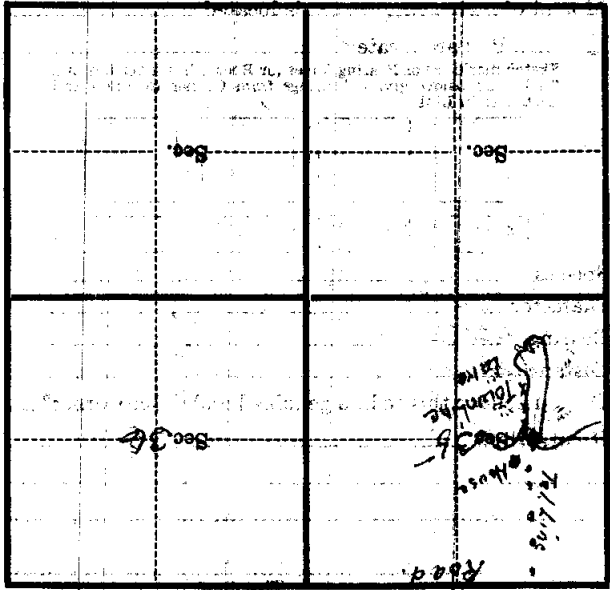

(Make sketch of topography near Corner)