

U. S. Department of Agriculture  
FOREST SERVICE

*Chippewa*

*Posted 2-9*

NATIONAL FOREST

CORNERS OF THE PUBLIC SURVEY

T. *142* R. *28* Mer. *5*

*1/4* *Cor.* Corner common to Sections  
*16*, and *17*

Corner consists of a *G.L.O. Brass Cap* (not) in place  
State condition *Good*

Dimensions above ground *14"* inches

Sketch grooves, letters, figures, or notches, on proper face or edge.

CARDINAL POSITION

DIAGONAL POSITION

	<i>17</i>		<i>16</i>
N	W	S	E

NW	SW	SE	NE

Mound of \_\_\_\_\_ is located \_\_\_\_\_

Pits are located \_\_\_\_\_

Sketch markings of Bearing Trees (or Rocks) in proper box and fill blanks below, giving bearings from Corner to Trees and Distances in Links.

	<i>17</i>		

Species *Dead Tree*

Diameter *10"*

Bearing *N. 30 W.*

Distance *120 Lks*

Do you believe this to be a genuine Land Office Corner? *Yes*

If not, why? \_\_\_\_\_

*R. H. M. Teacher*

(Signature)

*E. Starnes*

(Title)

*3/29/35*  
(Date)

U. S. Department of Agriculture

COURSE OF THE PUBLIC SURVEY

Corner again

Give any further facts which will aid in finding this

chain distant.

From which this Corner bears

130 7/8 S 36° E

side of 1/4 Cor.

tree 18 inches diameter, on the N.W.

Metal Location Poster is on a

1 am

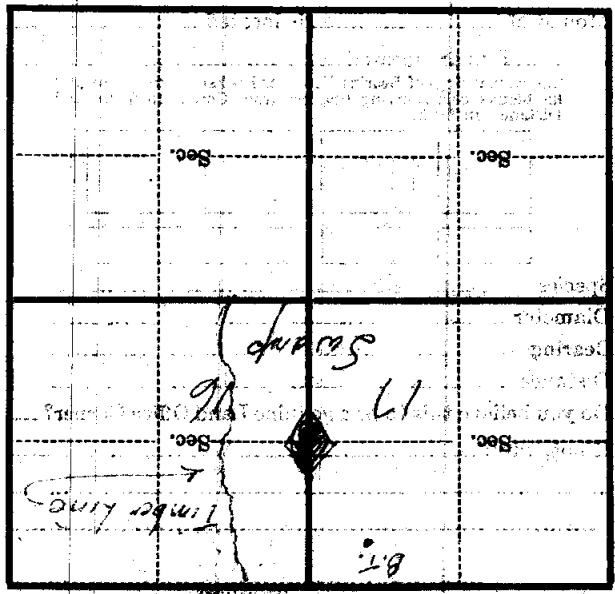

(Make sketch of topography near Corner)