

U. S. Department of Agriculture

FOREST SERVICE

Chippewa NATIONAL FOREST *Posted 2-9*

CORNERS OF THE PUBLIC SURVEY

T. 142 R. 28 5 Mer.

Sec. Corner common to Sections

4, 5, 32, and 33

Corner consists of a Brass cap G.L.O. (mark) in place

State condition Good

Dimensions above ground 14" inches

Sketch grooves, letters, figures, or notches, on proper face or edge.

CARDINAL POSITION

DIAGONAL POSITION

--	--	--	--

N W S E

32	5	4	33
----	---	---	----

NW SW SE NE

Mound of _____ is located _____

Pits are located _____

Sketch markings of Bearing Trees (or Rocks) in proper box and fill blanks below, giving bearings from Corner to Trees and Distances in Links.

		<u>Sec 4</u> <u>142</u> <u>28</u>	<u>Sec 33</u> <u>142</u> <u>28</u>

Species Balm Balm Balm

Diameter 18" 18"

Bearing S. 10° E. N. 10° E.

Distance 45 Lks 50 Lks

Do you believe this to be a genuine Land Office Corner? Yes

If not, why? _____

R. G. M. Roach

(Signature)

Estimator

(Title)

3/20/35
(Date)

Corner again.
Telephone home runs
along E & W line

Give any further facts which will aid in finding this
H.S. 115
from which this Corner bears N 10° W
side of Sec. 6 or
tree 18 inches diameter, on the S.E.
Metal Location Poster is on a
Bald

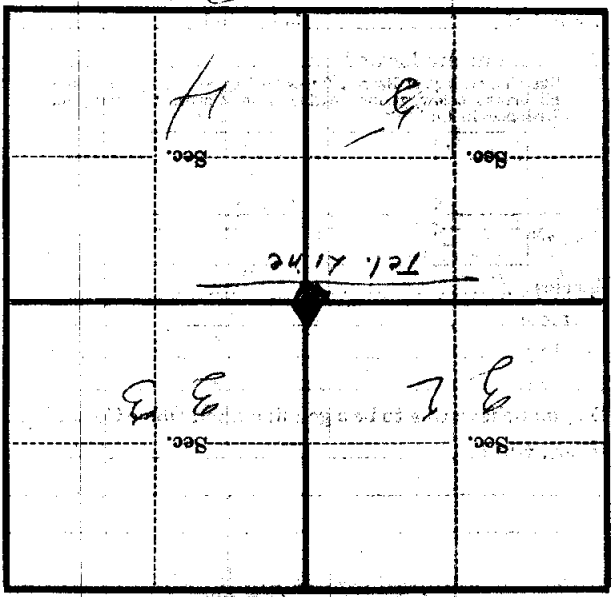

(Make sketch of topography near Corner)