

U. S. Department of Agriculture

FOREST SERVICE

U-66

CHIPPEWA NATIONAL FOREST

CORNERS OF THE PUBLIC SURVEY

T. 142 R. 27 5 Mer.
M.C. Corner common to Sections

29, and 32
 Corner consists of a brass cap (out) in place
 State condition good

Dimensions above ground 24 inches
 Sketch grooves, letters, figures, or notches, on proper face or edge.

CARDINAL POSITION

S. 29		S. 32	
N	W	S	E

DIAGONAL POSITION

S. 29			S. 29
NW	SW	SE	NE

Mound of _____ is located _____

Pits are located _____

Sketch markings of Bearing Trees (or Rocks) in proper box and fill blanks below, giving bearings from Corner to Trees and Distances in Links.

Species N. O. N. E.
 Diameter _____
 Bearing _____
 Distance _____

Do you believe this to be a genuine Land Office Corner? **Yes**
 If not, why? _____

R. T. DeFaut
 Raymond T. DeFaut
 (Signature)

6-17-40
 (Date)

Jr. Civil Engineer
 (Title)

S.M. 02

29

29

9

9

Corner again.

Give any further facts which will aid in finding this

chain distant

15

from which this Corner bears

N.E. 10°

side of

tree

tree 12 inches diameter, on the N.E.

Metal Location Poster is on a

RM

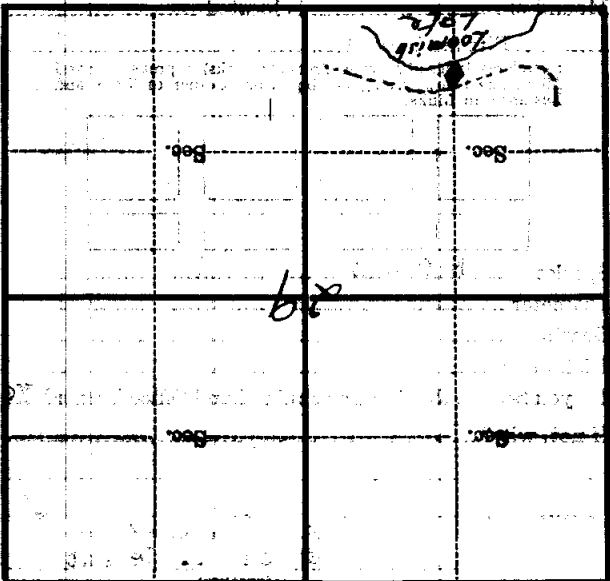

(Please sketch of topography near Corner)

T. 142

R.

27

5

Met.

Form 874-9—Revised May, 1918
U. S. Department of Agriculture
FOREST SERVICE

U;V-6

CHIPPewa NATIONAL FOREST

CORNERS OF THE PUBLIC SURVEY

T. 142 R. 27 S Mer.
M. O.

Corner common to Sections

29, and ~~30~~

Corner consists of a brass cap (and) in place

State condition good

Dimensions above ground 24 inches

Sketch grooves, letters, figures, or notches, on proper face or edge.

CARDINAL POSITION

DIAGONAL POSITION

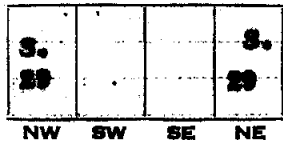

Mound of _____ is located _____

Pits are located _____

Sketch markings of Bearing Trees (or Rocks) in proper box and fill blanks below, giving bearings from Corner to Trees and Distances in Links.



Species N O N E

Diameter _____

Bearing _____

Distance _____

Do you believe this to be a genuine Land Office Corner? Yes

If not, why? _____

R. T. DeFaut
Raymond T. DeFaut

(Signature)

Jr. Civil Engineer

6-17-40

(Date)

(Title)

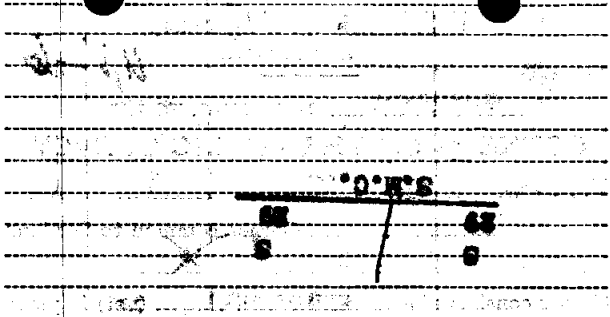

Corner again.

Give any further facts which will aid in finding this

chain distant

from which this Corner bears

N.E. 10°

15

side of

tree inches diameter, on the

N.E.

Metal Location Poster is on a

N.E.

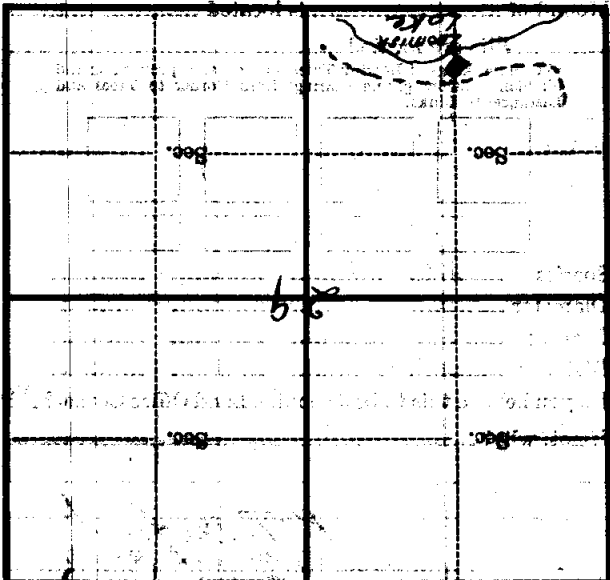

(Make sketch of topography near Corner)

11-6
Mer.

R.

T.