

U. S. Department of Agriculture

FOREST SERVICE

07,8 P.

Chippewa

NATIONAL FOREST

CORNERS OF THE PUBLIC SURVEY

T. 142 N R. 27 W S Mer.

MC Corner common to Sections

20, and

Corner consists of a *Iron's Iron Nail* in place

State condition

Dimensions above ground 14 inches

Sketch grooves, letters, figures, or notches, on proper face or edge.

CARDINAL POSITION

DIAGONAL POSITION

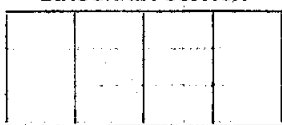
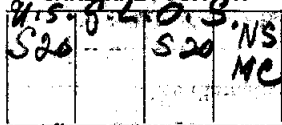

N W S E

NW SW SE NE

Mound of is located

Pits are located

Sketch markings of Bearing Trees (or Rocks) in proper box and fill blanks below, giving bearings from Corner to Trees and Distances in Links.

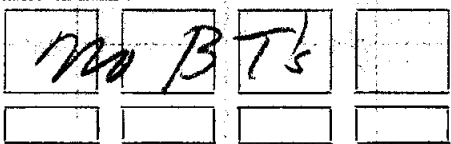

Species

Diameter

Bearing

Distance

Do you believe this to be a genuine Land Office Corner? *Yes*

If not, why?

*Robert Pennington*  
*Estimate*

(Date)

(Title)

*Corner again*  
*Dr. J. G. ...*  
*... - ...*

Metal Location Poster is on a  
three inches diameter, on the  
side of  
from which this Corner bears  
chains distant.  
Give any further facts which will aid in finding this

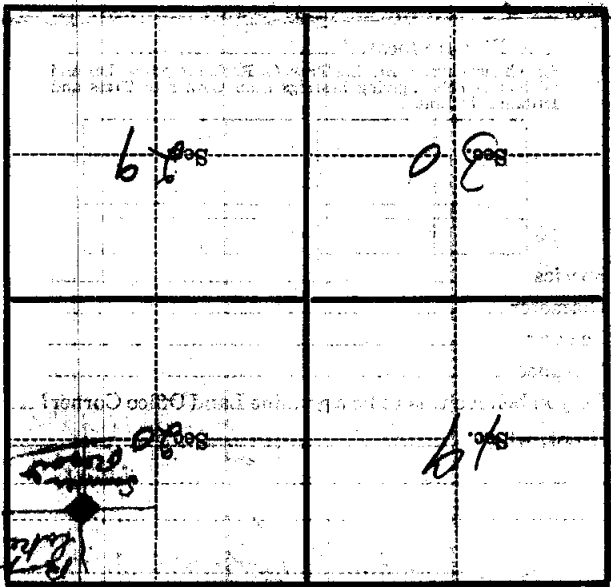

(Make sketch of topography near Corner)