

U. S. Department of Agriculture
FOREST SERVICE

CHIPPEWA NATIONAL FOREST

CORNERS OF THE PUBLIC SURVEY

T. 142 N R. 27 W 5th. Mer.

Meander

Corner common to Sections

17, and 20

Corner consists of a 1" pipe with cap in place

State condition good

Dimensions above ground 9" inches

Sketch grooves, letters, figures, or notches, on proper face or edge.

CARDINAL POSITION

DIAGONAL POSITION

--	--	--	--

N W S E

--	--	--	--

NW SW SE NE

Mound of _____ is located _____

Pits are located _____

Sketch markings of Bearing Trees (or Rocks) in proper box and fill blanks below, giving bearings from Corner to Trees and Distances in Links.

<u>T142 N</u> <u>R27 W</u> <u>917</u> <u>M.C.</u>			
<u>B.T.</u>			

Species R. Oak

Diameter 14"

Bearing N 84° W

Distance 80 lks.

Do you believe this to be a genuine Land Office Corner? Yes

If not, why? _____

No indication of corner

W. Skifstrom

(Signature)

Estimator

4/3/35

(Date)

(Title)

check location - OK

Corner again

Give any further facts which will aid in finding this

chains distant.

from which this Corner bears S 80° E

side of

tree 6 inches diameter, on the SE

Metal Location Poster is on a Aspen

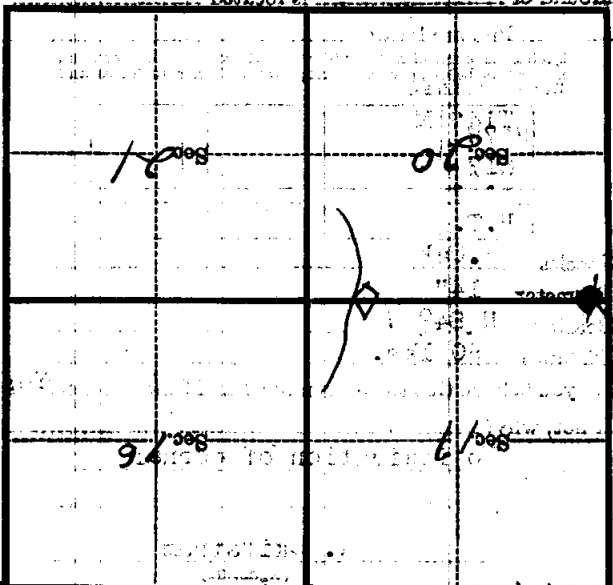

(Make sketch of topography near Corner)

N-89

N8,9

U. S. Department of Agriculture
FOREST SERVICE

Chippewa NATIONAL FOREST

CORNERS OF THE PUBLIC SURVEY

T. 142N R. 27W 5th Mer.

Meander Corner common to Sections
17, and 20

Corner consists of a 1" Pipe with Cap (not) in place
State condition Good

Dimensions above ground 9" inches

Sketch grooves, letters, figures, or notches, on proper face or edge.

CARDINAL POSITION

DIAGONAL POSITION

--	--	--	--

--	--	--	--

N W S E

NW SW SE NE

Mound of _____ is located _____

Pits are located _____

Sketch markings of Bearing Trees (or Rocks) in proper box and fill blanks below, giving bearings from Corner to Trees and Distances in Links.

T 142 N
R 27 W
S 17
M.C.

--

--

--

B.T.

--

--

--

Species P. Oak

Diameter 14"

Bearing N 84 W

Distance 80 lks.

Do you believe this to be a genuine Land Office Corner? Yes

If not, why? No indication of Cor.

W. Skifstrom

(Signature)

Estimator

(Title)

4/3/35
(Date)

UNITED STATES DEPARTMENT OF AGRICULTURE
 BUREAU OF LAND MANAGEMENT
 NATIONAL FOREST

Corner again.
 Give any further facts which will aid in finding this
 chains distant.
 from which this Corner bears
 side of
 tree 6 inches diameter, on the
 Metal Location Poster is on a
 Aspen S E

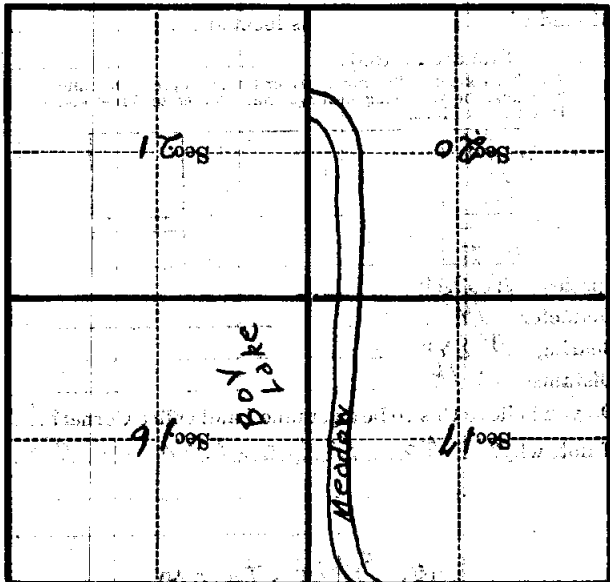

(Make sketch of topography near Corner)