

U. S. Department of Agriculture

FOREST SERVICE

15

CHIPPEWA NATIONAL FOREST

CORNERS OF THE PUBLIC SURVEY

T. 142 R. 27 5 Mer.

Section _____ Corner common to Sections

29, 30, 31, and 32

Corner consists of a Brass cap (~~cap~~) in place

State condition good

Dimensions above ground 10 inches

Sketch grooves, letters, figures, or notches, on proper face or edge.

CARDINAL POSITION

DIAGONAL POSITION

--	--	--	--

S.	S.	S.	S.
30	31	32	29

N W S E

NW SW SE NE

Mound of _____ is located _____

Pits are located _____

Sketch markings of Bearing Trees (or Rocks) in proper box and fill blanks below, giving bearings from Corner to Trees and Distances in Links.

S. 29	S. 30	S. 31	S. 32

Species Maple Maple Maple Maple

Diameter 20" 8" 20" 6"

Bearing N25°E N35°W S26°W S14°E

Distance .35 .40 .32 .38

Do you believe this to be a genuine Land Office Corner? Yes

If not, why? _____

R. T. DeFaut
Raymond T. DeFaut

(Signature)

Jr. Civil Engineer

6-17-40

(Date)

(Title)

See also taken at Map 1011

Corner again.

Give any further facts which will aid in finding this

chains distant.

from which this Corner bears

S35° E

side of

tree

tree 8 inches diameter, on the S21° E

Metal Location Poster is on a

maple

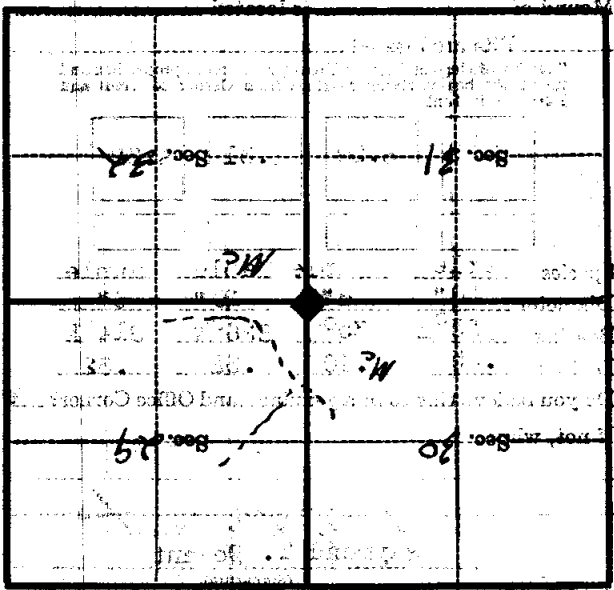

(Make sketch of topography near Corner)

T. 142 R. 27 S. 5 Mer. V-5