

Form 874-B—Revised May, 1928
 U. S. Department of Agriculture
 FOREST SERVICE

2-23

Chippewa NATIONAL FOREST

CORNERS OF THE PUBLIC SURVEY

T. 142 R. 25 Mer. 5

Sec. 1 Corner common to Sections

36, 37, and 38

Corner consists of a post in place

State condition fair

Dimensions above ground 15" inches

Sketch grooves, letters, figures, or patches, on proper face or edge.

CARDINAL POSITION

DIAGONAL POSITION

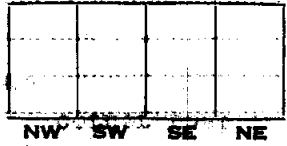

Found of is located

Pits are located

Sketch markings of Bearing Trees (or Rocks) in proper box and fill blanks below, giving bearings from Corner to Trees and Distances in Links.

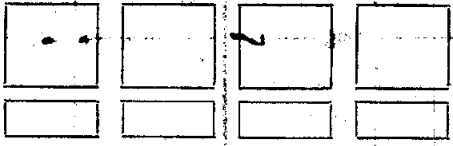

Species

Diameter

Bearing

Distance

Do you believe this to be a genuine Land Office Corner? No.

If not, why? County Corner

R. T. Defant
 Raymond T. Defant
 (Signature)

3-16-40
 (Date)

Jr. Civil Engineer
 (Title)

Follow ~~front~~ on fence line.

Corner is S. E. of Building

Corner again.

Give any further facts which will aid in finding this

chains distant.

from which this Corner bears

side of

tree inches diameter, on the

Metal Location Poster is on a corner post

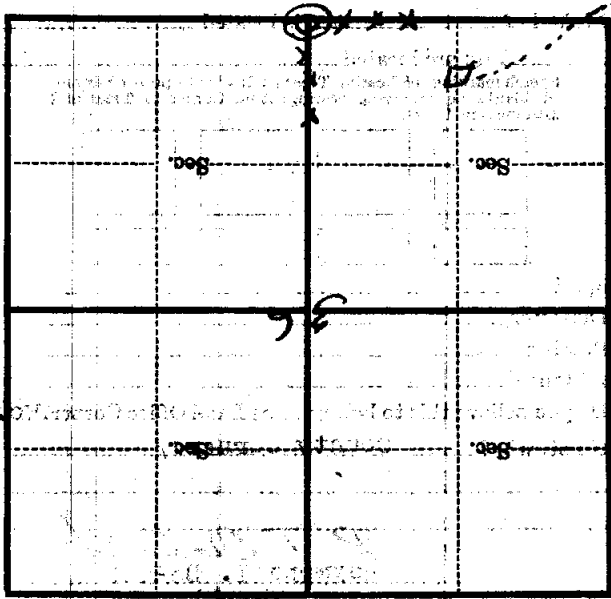

(Make sketch of topography near Corner)

U. S. Department of Agriculture

FOREST SERVICE

Z-23

Chippewa NATIONAL FOREST

CORNERS OF THE PUBLIC SURVEY

T. 142 R. 28 S. 5 Mer.Sec. 4 So. 1/4 Corner common to Sections
26, 27, 28, and 29Corner consists of a post (set) in placeState condition fairDimensions above ground 15" inches

Sketch grooves, letters, figures, or notches, on proper face or edge.

CARDINAL POSITION

DIAGONAL POSITION

--	--	--	--

N W S E

--	--	--	--

NW SW SE NE

Mound of is located Pits are located

Sketch markings of Bearing Trees (or Rocks) in proper box and fill blanks below, giving bearings from Corner to Trees and Distances in Links.

Species Diameter Bearing Distance Do you believe this to be a genuine Land Office Corner? No.If not, why? County Corner

R. T. Defant
 Raymond T. Defant
 (Signature)

Jr. Civil Engineer

5-16-40

(Date)

(Title)

FIELD NOTES

DATE

LOCATION

CORNERS OF THE PUBLIC SURVEY

Follow Post on Town Line.

Corner is S.E. of Building

Corner again

Give any further facts which will aid in finding the

chain distant

from which this Corner bears

side of

tree inches diameter, on the

Metal Location Poster is on a

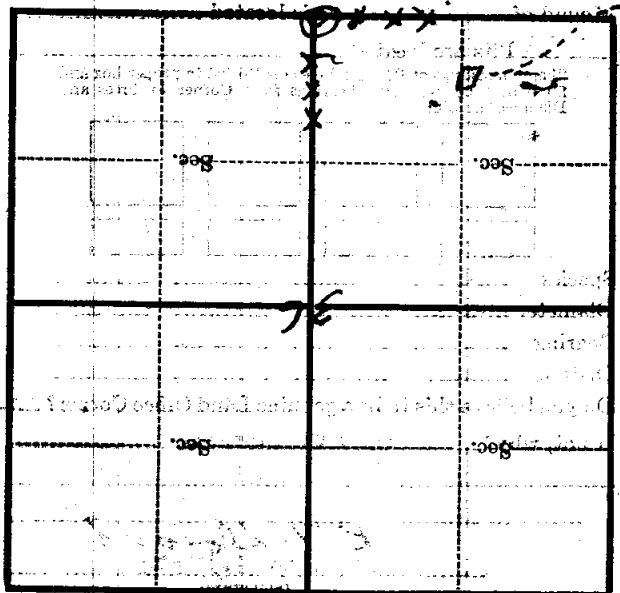

(Make sketch of topography near Corner)