

Form 874-S—Revised May, 1918
U. S. Department of Agriculture
FOREST SERVICE

6-9

Chippewa NATIONAL FOREST

CORNERS OF THE PUBLIC SURVEY

T. 142N R. 25W 5th Mer.

1 Corner common to Sections

8, and 9

Corner consists of a Cedar Post (not) in place

State condition Fair

Dimensions above ground 30" inches

Sketch grooves, letters, figures, or notches, on proper face or edge.

CARDINAL POSITION

DIAGONAL POSITION

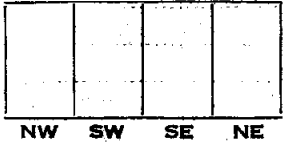
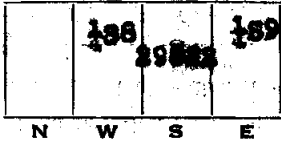

Mound of _____ is located _____

Pits are located _____

Sketch markings of Bearing Trees (or Rocks) in proper box and fill blanks below, giving bearings from Corner to Trees and Distances in Links.



Species _____

Diameter _____

Bearing _____

Distance _____

Do you believe this to be a genuine Land Office Corner? No

If not, why? C. C.

Arthur H. Jager
ARTHUR H. JAGER

(Signature)

CHIEF OF PARTY

8/26/36

(Date)

(Title)

(Make sketch of topography near Corner, etc.)

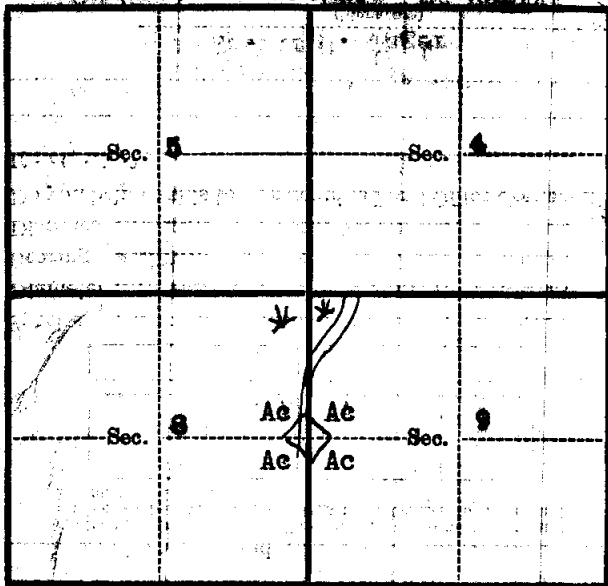

Metal Location Poster is on a 1 Aspen
 tree _____ inches diameter, on the East
 side of Tree
 from which this Corner bears N84°E
3.43 chains distant.

Give any further facts which will aid in finding this
 Corner again.

U. S. Department of Agriculture
FOREST SERVICE

69

Chippewa NATIONAL FOREST

CORNERS OF THE PUBLIC SURVEY

T. 142N R. 25W 5th Mer.

$\frac{1}{4}$ Corner common to Sections

8, and 9

Corner consists of a Cedar Post (~~stone~~) in place

State condition Fair

Dimensions above ground 30" inches

Sketch grooves, letters, figures, or notches, on proper face or edge.

CARDINAL POSITION

DIAGONAL POSITION

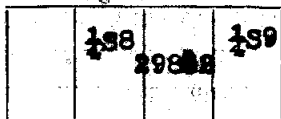

N W S E

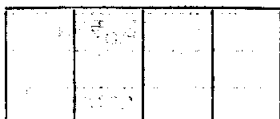

NW SW SE NE

Mound of _____ is located _____

Pits are located _____

Sketch markings of Bearing Trees (or Rocks) in proper box and fill blanks below, giving bearings from Corner to Trees and Distances in Links.



Species _____

Diameter _____

Bearing _____

Distance _____

Do you believe this to be a genuine Land Office Corner? Yes

If not, why? _____

Arthur H. Jager
Arthur H. Jager

(Signature)

Chief of Party

8/26/36

(Date)

(Title)

(Make sketch of topography near Corner)

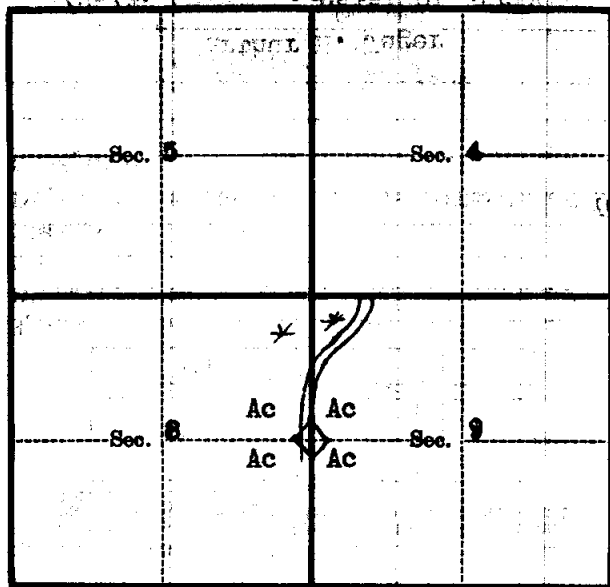

Metal Location Poster is on a Aspen
 tree _____ inches diameter, on the East
 side of Section 6
 from which this Corner bears N84°E
0.49 chains distant.

Give any further facts which will aid in finding this
 Corner again.