

R-9

~~OREGON~~ NATIONAL FOREST

CORNERS OF THE PUBLIC SURVEY

T. 142 R. 22 S. 8 Mer.

Section

Corner common to Sections

22, 21, 20, and 19

Corner consists of a _____ (not) in place
 State condition _____

Dimensions above ground _____ inches

Sketch grooves, letters, figures, or notches, on proper face or edge.

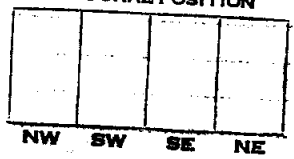
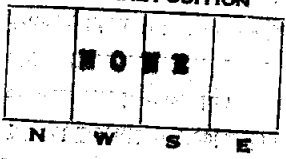

Mound of _____ is located _____

Pits are located _____

Sketch markings of Bearing Trees (or Rocks) in proper box and fill blanks below, giving bearings from Corner to Trees and Distances in Links.

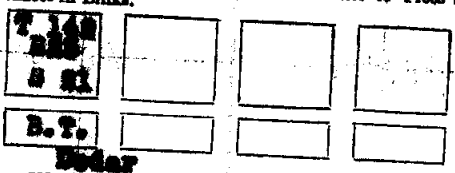

Species Redar
 Diameter 15"
 Bearing N80°E
 Distance 14

Do you believe this to be a genuine Land Office Corner? **Yes**
 If not, why? _____

R. T. DeFaut
 Raymond T. DeFaut
 (Signature)

CIVIL ENGINEER
 (Title)

8-8-20
 (Date)

NOT FROM PIPE AT CORNER.

POSTER ON ORIGINAL ALSO HERE
Corner again.

Give any further facts which will aid in finding this

chain's distant

from which this Corner bears

side of

tree inches diameter, on the

Metal Location Posters on a

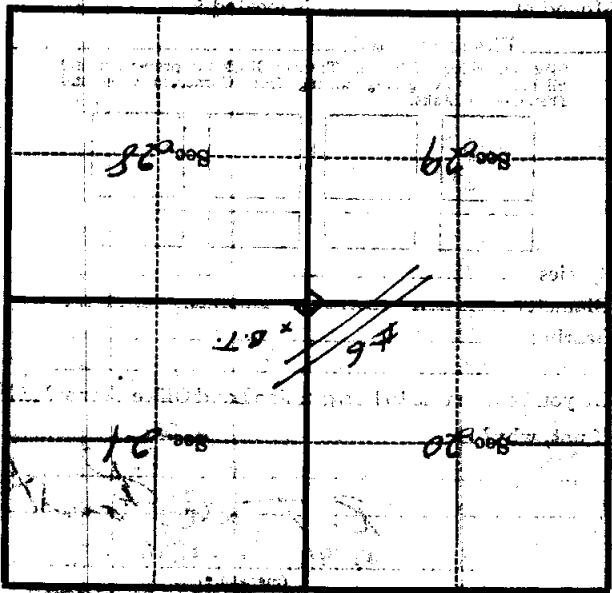

(Make sketch of topography near Corner)