

U. S. Department of Agriculture

FOREST SERVICE

*Wipac* NATIONAL FOREST *Posted 51-2*

CORNERS OF THE PUBLIC SURVEY

T. 141 R. 31 Mer. 5

MEANDER Corner common to Sections

7, and 18

Corner consists of a IRON PIPE (not) in place

State condition Good

Dimensions above ground 8 inches

Sketch grooves, letters, figures, or notches, on proper face or edge.

CARDINAL POSITION

DIAGONAL POSITION

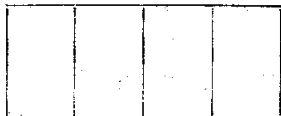

N W S E



NW SW SE NE

Mound of \_\_\_\_\_ is located \_\_\_\_\_

Pits are located \_\_\_\_\_

Sketch markings of Bearing Trees (or Rocks) in proper box and fill blanks below, giving bearings from Corner to Trees and Distances in Links.

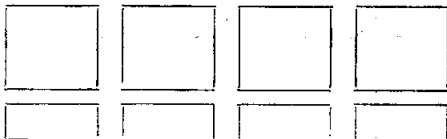

Species \_\_\_\_\_

Diameter \_\_\_\_\_

Bearing \_\_\_\_\_

Distance \_\_\_\_\_

Do you believe this to be a genuine Land Office Corner? No

If not, why? COUNTY SUBDIVIDED

*Dave Prestidge*

(Signature)

4/3/35

(Date)

*E. Hunter*

(Title)

Corner again.  
THIS CORNER NOW 125'  
LINKS FROM WATER'S EDGE  
ON WEST SIDE OF LAKE ALICE  
ON SEC. LINE BETWEEN T AND  
18

Metal Location Poster is on a N ASPEN  
tree 4 inches diameter, on the NORTH  
side of MEANDER CORNER  
from which this Corner bears  
383 LINKS chains distant.  
Give any further facts which will aid in finding this

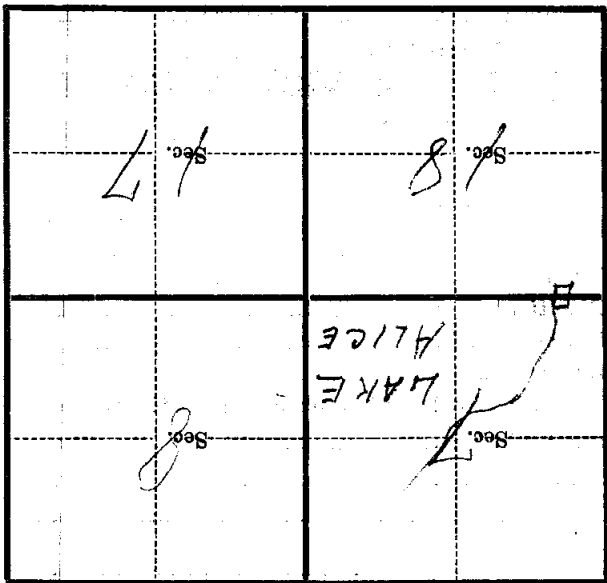

(Make sketch of topography near Corner)