

U. S. Department of Agriculture  
FOREST SERVICE

R-17

Chippewa NATIONAL FOREST

CORNERS OF THE PUBLIC SURVEY

T. 141 N R. 29 W 5th Mer.

Section Corner common to Sections

22, 23, 26, and 27

Corner consists of a 2" I.M. & brass cap (not) in place

State condition good

Dimensions above ground 6 inches

Sketch grooves, letters, figures, or notches, on proper face or edge.

CARDINAL POSITION

DIAGONAL POSITION

			22/23 26/27				
N	W	S	E	NW	SW	SE	NE

Mound of \_\_\_\_\_ is located \_\_\_\_\_

Pits are located \_\_\_\_\_

Sketch markings of Bearing Trees (or Rocks) in proper box and fill blanks below, giving bearings from Corner to Trees and Distances in Links.

T141 R29 S27	T141 R29 S26	Scribble GROWN OVER	T141 R29 S23
B.T.	B.T.	B.T.	B.T.

Species J. Pine J. Pine W. Oak J. Pine  
Diameter 10" 6" 12" 16"  
Bearing S22°W S14°E N66°W N54°E  
Distance 77 lks 117 lks 133 lks 176 lks.

Do you believe this to be a genuine Land Office Corner? yes  
If not, why? \_\_\_\_\_

*Arthur T. Johnson*  
Arthur T. Johnson  
(Signature)

3/23/38  
(Date)

Semi-skilled Worker  
(Title)

R-17

Corner again.  
This corner lies 1/4 mile west  
of old grade across old meadow.

Give any further facts which will aid in finding this  
chains distant.

from which this Corner bears  
side of  
tree inches diameter, on the  
Metal Location Poster is on a

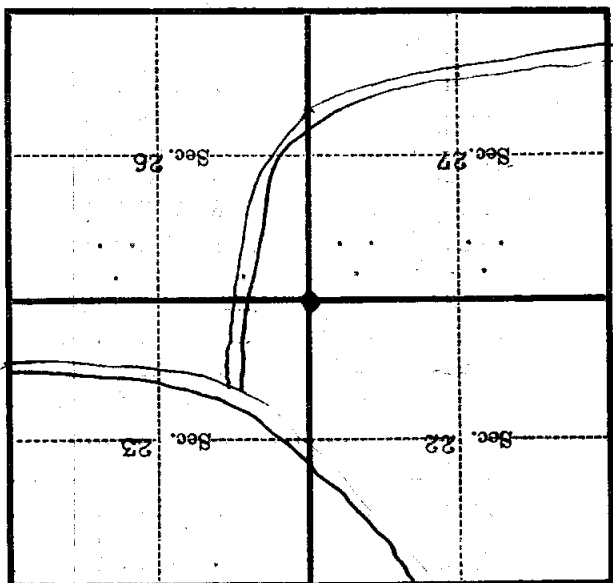

(Make sketch of topography near Corner)

Mer.

5th

R. 29 E

T. 141 N

R-17