

U. S. Department of Agriculture  
FOREST SERVICE

R-16

Chippewa NATIONAL FOREST

CORNERS OF THE PUBLIC SURVEY

T. 141 N R. 29 W 5<sup>th</sup> Mer.  
E 1/16 Corner common to Sections

....., 22, and 27

Corner consists of a 1 1/2" Brass Cap (not) in place

State condition Good

Dimensions above ground 6" inches

Sketch grooves, letters, figures, or notches, on proper face or edge.

CARDINAL POSITION

DIAGONAL POSITION

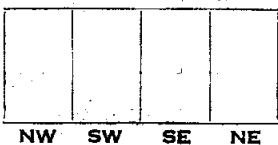
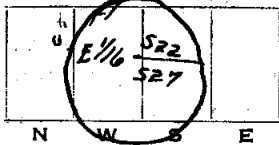

Mound of ..... is located .....

Pits are located .....

Sketch markings of Bearing Trees (or Rocks) in proper box and fill blanks below, giving bearings from Corner to Trees and Distances in Links.



Species .....

Diameter .....

Bearing .....

Distance .....

Do you believe this to be a genuine Land Office Corner? Yes

If not, why? .....

Carl Steadland

(Signature)

Const. For.

(Title)

June 1936

(Date)

R-16

Corner again.

Give any further facts which will aid in finding this

chains distant.

0.65

S 41 W

from which this Corner bears

side of

tree 4" inches diameter, on the

Aspen

Metal Location Poster is on a

	Sec.		Sec.
	Sec.		Sec.

(Make sketch of topography near Corner)

R-16 Mer.

T. 141 R. 29