

U. S. Department of Agriculture
FOREST SERVICE

Posted M-13

Chippewa. NATIONAL FOREST

CORNERS OF THE PUBLIC SURVEY

T. *141N* R. *29W* *5th* Mer.
5/16 Corner common to Sections

....., *16*, and *15*
Corner consists of a *Brass plate* (not) in place
State condition *O.K.*

Dimensions above ground *2 1/2" dia.* inches
Sketch grooves, letters, figures, or notches, on proper face or edge.

CARDINAL POSITION

DIAGONAL POSITION

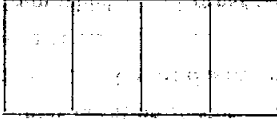

N W S E

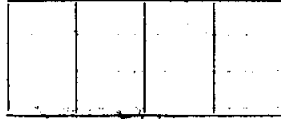

NW SW SE NE

Mound of is located

Pits are located

Sketch markings of Bearing Trees (or Rocks) in proper box and fill blanks below, giving bearings from Corner to Trees and Distances in Links.

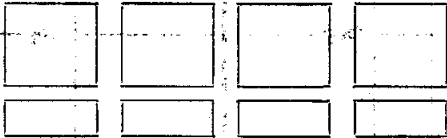

Species
Diameter
Bearing
Distance

Do you believe this to be a genuine Land Office Corner? *Yes*

If not, why?

[Signature]
(Signature)

ENGINEER
(Title)

3/26/35
(Date)

M-13

SECTION 16
 T. 141N. R. 29W.
 CORNER NEAR
 SECTION 16

Corner again.

Give any further facts which will aid in finding this
 station distant
 from which this Corner bears
 side of
 tree
 inches diameter, on the
 Metal Location Poster is on a

NONE

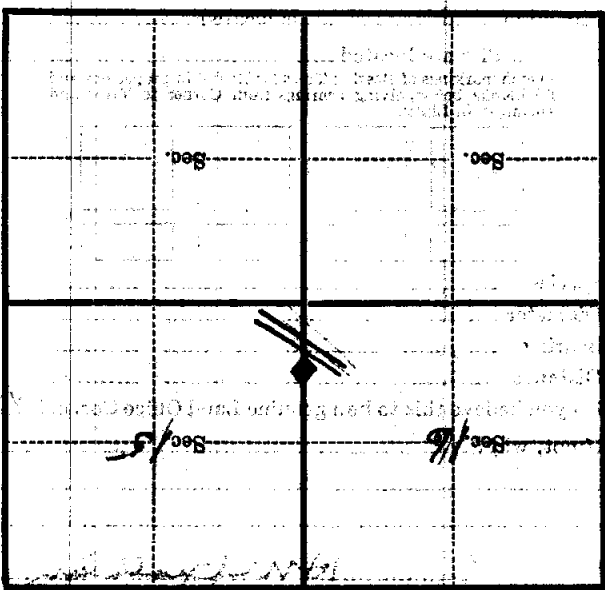

(Make sketch of topography near Corner)

T. 141N. R. 29W.
 Mer. 11-13