

U. S. Department of Agriculture
FOREST SERVICE

Chippewa

Noted G-1

NATIONAL FOREST

CORNERS OF THE PUBLIC SURVEY

T. *14* R. *29*^{*23*} S. *5* Mer.

14 Corner common to Sections

7, and *12*

Corner consists of a *Galv. Brass cap* (not) in place

State condition *Good*

Dimensions above ground *14"* inches

Sketch grooves, letters, figures, or notches, on proper face or edge.

CARDINAL POSITION

DIAGONAL POSITION

<i>12</i>			<i>7</i>
-----------	--	--	----------

--	--	--	--

N W S E NW SW SE NE

Mound of _____ is located _____

Pits are located _____

Sketch markings of Bearing Trees (or Rocks) in proper box and fill blanks below, giving bearings from Corner to Trees and Distances in Links.

<i>None</i>			

Species _____

Diameter _____

Bearing _____

Distance _____

Do you believe this to be a genuine Land Office Corner? *Yes*

If not, why? _____

B. J. McEachern

(Signature)

7-2/25

(Date)

Estimator

(Title)

G-1

U. S. GEOLOGICAL SURVEY

CORNER OF THE BENTON RAILROAD

Corner again
Add swings around
Swamp at corner

Give any further facts which will aid in finding this

station distant.

15' from which this Corner bears Due N.

side of $\frac{1}{4}$ cor.

tree 8" inches diameter, on the 150'

Metal Location Poster is on a $\frac{1}{2}$ belt

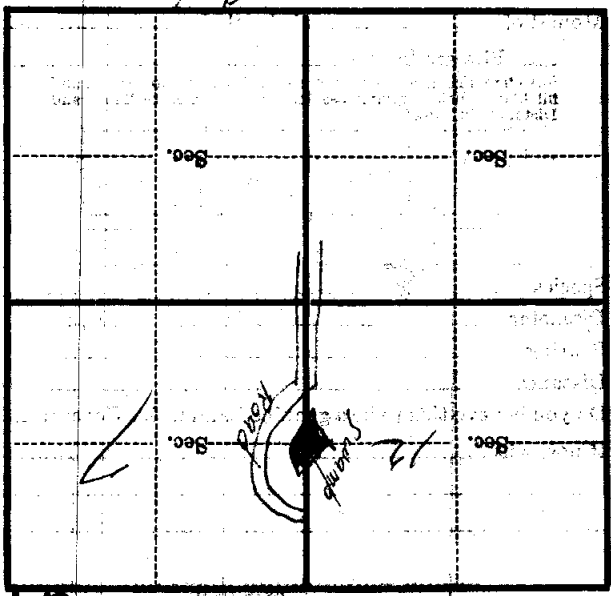

(Make sketch of topography near Corner)

Mer. 5-1

T 141 R 29