

Form 874-9—Revised May, 1918
U. S. Department of Agriculture
FOREST SERVICE

Posted
12/11/20
T. U. - 15

---Chippewa--- NATIONAL FOREST

CORNERS OF THE PUBLIC SURVEY

T. 141 R. 27 Mer. 5

---M. C.--- Corner common to Sections
---, 27, and ---

Corner consists of a --- (not) in place
State condition ---

Dimensions above ground --- inches
Sketch grooves, letters, figures, or notches, on proper face or edge.

CARDINAL POSITION

DIAGONAL POSITION

N	W	S	E

NW	SW	SE	NE

Mound of --- is located ---

--- Pits are located ---

Sketch markings of Bearing Trees (or Rocks) in proper box and
fill blanks below, giving bearings from Corner to Trees and
Distances in Links.

S27			
M. C.			
B. T.			

Species Ash ---

Diameter 14 ---

Bearing corner ---

Distance ---

Do you believe this to be a genuine Land Office Corner? no

If not, why? Company Corner

R. Defant
R. Defant (Signature)

10-31-40
(Date)

J. E.
(Title)

100 ft. west of road

Corner again.

Give any further facts which will aid in finding the

chain distant corner

from which corner bears

side 14

tree inches diameter, on the N. E. corner

Metal Location Poster is on a

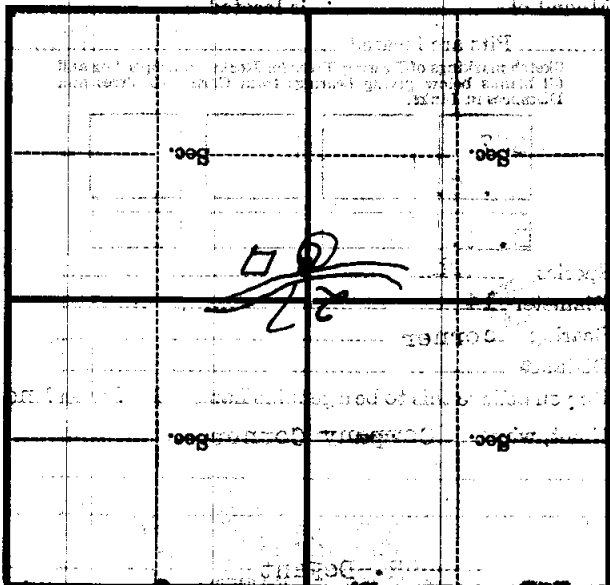

(Make sketch of topography near corner)

TU-15

Mer.

R

T