

Form 874-9—Revised May, 1918  
U. S. Department of Agriculture  
FOREST SERVICE

4-24  
8-24

CHIPPENAW NATIONAL FOREST

CORNERS OF THE PUBLIC SURVEY

T. 141 R. 27 S. 5 Mer.

#13 1/16 Corner common to Sections

36, and

Corner consists of a iron rod (70) in place

State condition good

Dimensions above ground 18 inches

Sketch grooves, letters, figures, or notches, on proper face or edge.

CARDINAL POSITION

DIAGONAL POSITION

--	--	--	--

N W S E

--	--	--	--

NW SW SE NE

Mound of is located

Pits are located

Sketch markings of Bearing Trees (or Rocks) in proper box and fill blanks below, giving bearings from Corner to Trees and Distances in Links.

Species

Diameter

Bearing

Distance

Do you believe this to be a genuine Land Office Corner? No

If not, why? County Corner

R. T. Defant  
RAYMOND T. DEFANT  
(Signature)

Jr. Civil Engineer  
(Title)

7-3-40  
(Date)

Corner again.  
Corner is in low spot.  
Give any further facts which will aid in finding this

1.48 chains distant.  
from which this Corner bears East  
side of trees  
tree 8 inches diameter, on the East  
Metal Location Poster is on a Aspen

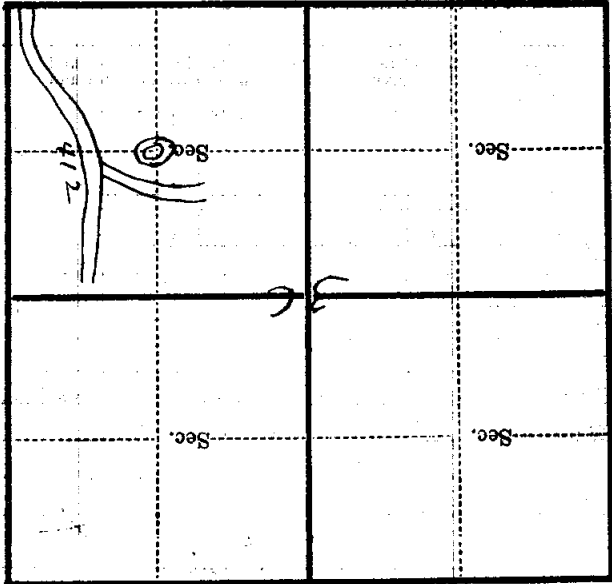

(Make sketch of topography near Corner)