

U. S. Department of Agriculture

FOREST SERVICE

T-13

CHIPPEWA NATIONAL FOREST

CORNERS OF THE PUBLIC SURVEY

T. 141 R. ~~86~~ 27 5 Mer.

$\frac{1}{4}$ Corner common to Sections 28, and 27

Corner consists of a _____ (not) in place State condition _____

Dimensions above ground _____ inches

Sketch grooves, letters, figures, or notches, on proper face or edge.

CARDINAL POSITION

DIAGONAL POSITION

| | | | |
|--|--|--|--|
| | | | |
|--|--|--|--|

N W S E

| | | | |
|--|--|--|--|
| | | | |
|--|--|--|--|

NW SW SE NE

Mound of _____ is located _____

Pits are located _____

Sketch markings of Bearing Trees (or Rocks) in proper box and fill blanks below, giving bearings from Corner to Trees and Distances in Links.

| | | | |
|-----------------------|--|--|--|
| $\frac{1}{4}$ S 27 | | | |
| | | | |

Species Maple _____

Diameter 10" _____

Bearing _____

Distance _____

Do you believe this to be a genuine Land Office Corner? No

If not, why? B.T. not indicative of GLO's corner may have been in when this tree was scribed.

R.P.

(Signature)

5/20/35

(Date)

Field Ass't

(Title)

At road into slab piles from portable mill
Corner again.

Give any further facts which will aid in finding the chains distant from which this Corner bears

side of tree
tree 10" inches diameter, on the S.W.
Metal Location Poster is on a Maple B.T.

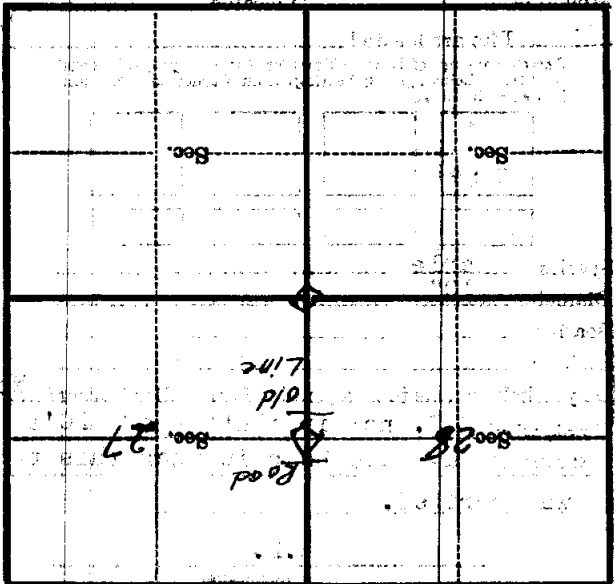

(Make sketch of topography near Corner)

Mer. T-13

5

27

R.

T. 141