

Form 874-9—Revised May, 1918  
U. S. Department of Agriculture  
FOREST SERVICE

F-5

CHIPPEWA NATIONAL FOREST

CORNERS OF THE PUBLIC SURVEY

T. 141 R. 27 Mer. 5

1/16 Corner common to Sections

7, and 8

Corner consists of a brass (iron) in place

State condition good

Dimensions above ground 4" inches

Sketch grooves, letters, figures, or notches, on proper face or edge.

CARDINAL POSITION

DIAGONAL POSITION

	S.		S.
	7		8

N W S E

NW SW SE NE

Mound of \_\_\_\_\_ is located \_\_\_\_\_

Pits are located \_\_\_\_\_

Sketch markings of Bearing Trees (or Rocks) in proper box and fill blanks below, giving bearings from Corner to Trees and Distances in Links.

Species N O N E

Diameter \_\_\_\_\_

Bearing \_\_\_\_\_

Distance \_\_\_\_\_

Do you believe this to be a genuine Land Office Corner? \_\_\_\_\_

If not, why? \_\_\_\_\_

*R. T. DeFant*  
Raymond T. DeFant  
(Signature)

Jr. Civil Engineer  
(Title)

6-17-40  
(Date)

Corner again.

Give any further facts which will aid in finding this

88 chains distant.

from which this Corner bears 960° E

side of tree

tree 14 inches diameter, on the S.E.

Metal Location Poster is on a W.P.

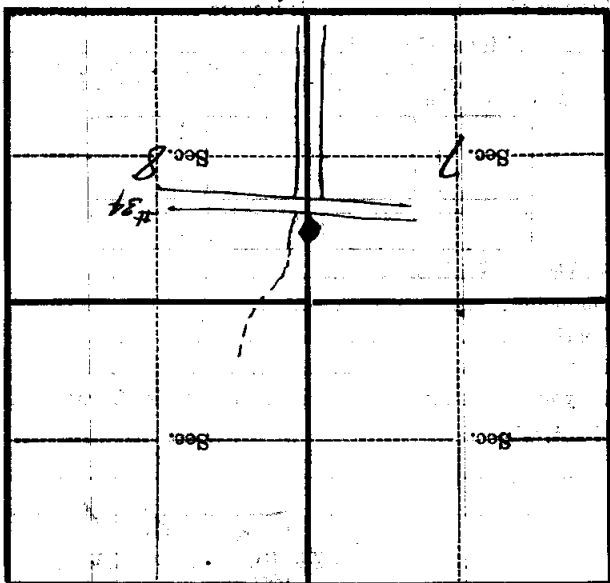

(Make sketch of topography near Corner)