

Form 974-9 Revised May, 1918
U. S. Department of Agriculture
FOREST SERVICE

R-3

CHIPPEWA NATIONAL FOREST

CORNERS OF THE PUBLIC SURVEY

T. 141 R. 26 5 Mer.

$\frac{1}{4}$ Corner common to Sections
19, and 30

Corner consists of a _____ (not) in place
State condition _____

Dimensions above ground _____ inches
Sketch grooves, letters, figures, or notches, on proper face or edge.

CARDINAL POSITION

DIAGONAL POSITION

--	--	--	--

N W S E

--	--	--	--

NW SW SE NE

Mound of _____ is located _____

Pits are located _____

Sketch markings of Bearing Trees (or Rocks) in proper box and fill blanks below, giving bearings from Corner to Trees and Distances in Links.

$\frac{1}{4}$ S 30			
B.T.			

Species N. Pine

Diameter 14"

Bearing S 35°W

Distance 100'

Do you believe this to be a genuine Land Office Corner? Yes

If not, why? No. Co. Co

H.M.K.

(Signature)

Engineer

(Title)

2/28/35

(Date)

Corner again.

Give any further facts which will aid in finding the

chains distant.

from which this Corner bears

side of

tree inches diameter, on the

Metal Location Poster is on a

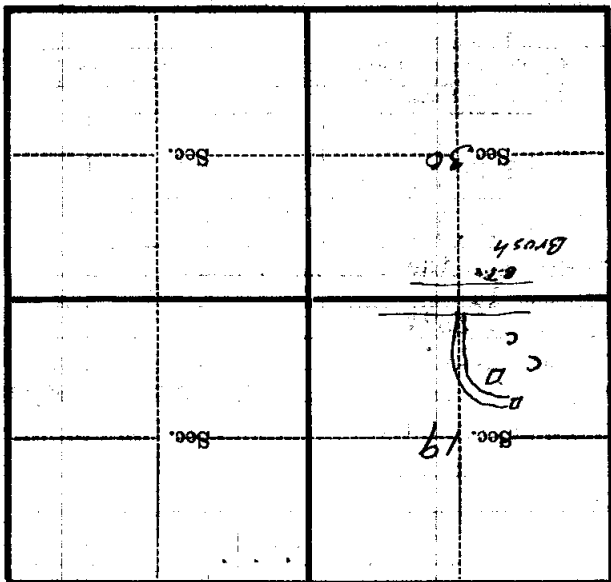

(Make sketch of topography near corner)

U. S. Department of Agriculture
FOREST SERVICE

R-3 P

NATIONAL FOREST

CORNERS OF THE PUBLIC SURVEY

T. 141 R. 26 5 Mer.

94 Corner common to Sections
19, and 30

Corner consists of a (not) in place
State condition

Dimensions above ground inches

Sketch grooves, letters, figures, or notches, on proper face or edge.

CARDINAL POSITION

DIAGONAL POSITION

--	--	--	--

N W S E

--	--	--	--

NW SW SE NE

Mound of is located

Pits are located

Sketch markings of Bearing Trees (or Rocks) in proper box and fill blanks below, giving bearings from Corner to Trees and Distances in Links.

14530			
BT			

Species N. Pine

Diameter 14

Bearing S35°W

Distance 100'

Do you believe this to be a genuine Land Office Corner? Yes

If not, why?

Handwritten Signature

(Signature)

ENGINEER

(Title)

2/28/95

(Date)

