

G-5

NATIONAL FOREST  
**CORNERS OF THE PUBLIC SURVEY**

T. 141 R. 25 Mer. 5  
1/4 Corner common to Sections

Corner consists of a 7, and 8  
 State condition \_\_\_\_\_ (not) in place

Dimensions above ground \_\_\_\_\_ inches  
 Sketch grooves, letters, figures, or notches, on proper face or edge.

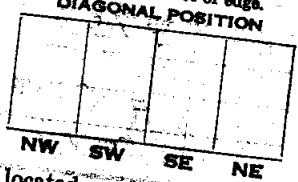
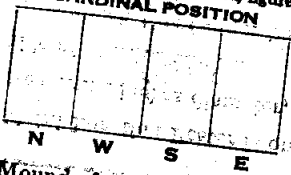

Mound of \_\_\_\_\_ is located \_\_\_\_\_

Pits are located \_\_\_\_\_

Sketch markings of Bearing Trees (or Rocks) in proper box and fill blanks below, giving bearings from Corner to Trees and Distances in Links.

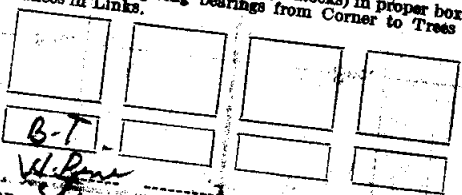

Species W. Pine  
 Diameter 3 1/2  
 Bearing S 43 E  
 Distance 491

Do you believe this to be a genuine Land Office Corner? Yes  
 If not, why? Ob. Cor.

8-8-41  
 (Date)

R. Defant  
 (Signature)

U.S. Department of Agriculture  
Forest Service

NATIONAL FOREST  
CORNERS OF THE PUBLIC SURVEY

*1/2 mile*  
*551.5*  
*551.5*

from which the Corner bears  
side of  
tree 6 inches diameter, on the  
Metal Location Forest is on a

*551.5*  
*551.5*  
*S.E.*

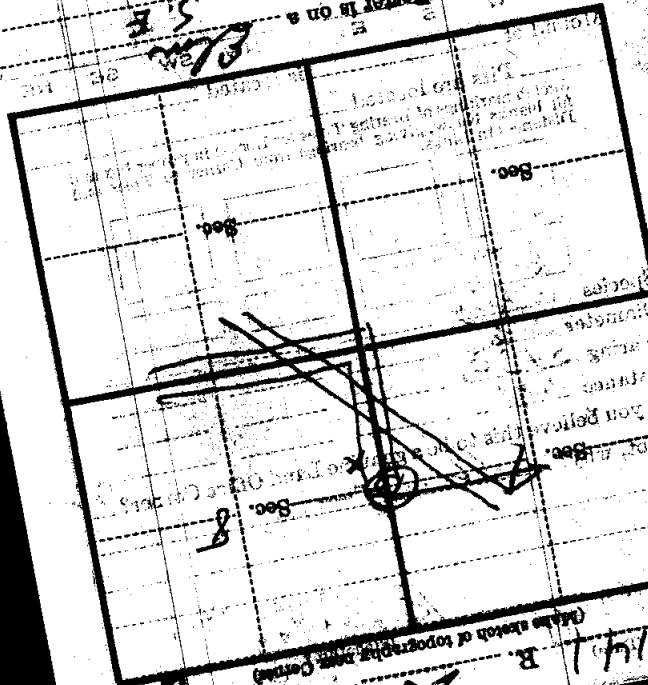

(Make sketch of topography of each Corner)

Mer. 5-5

25

141 B

G-5

U. S. Department of Agriculture  
FOREST SERVICE

NATIONAL FOREST

CORNERS OF THE PUBLIC SURVEY

T. 141 R. 25 S Mer.

1/4

Corner common to Sections

7, and 8

Corner consists of a \_\_\_\_\_ (not) in place

State condition \_\_\_\_\_

Dimensions above ground \_\_\_\_\_ inches

Sketch grooves, letters, figures, or notches, on proper face or edge.

CARDINAL POSITION

DIAGONAL POSITION

N	W	S	E

NW	SW	SE	NE

Mound of \_\_\_\_\_ is located \_\_\_\_\_

Pits are located \_\_\_\_\_

Sketch markings of Bearing Trees (or Rocks) in proper box and fill blanks below, giving bearings from Corner to Trees and Distances in Links.

B-T			

Species W. Pine

Diameter 5 1/2

Bearing S 43 E

Distance 491

Do you believe this to be a genuine Land Office Corner? Yes

If not, why? As Cor

*R. DeForest*  
*DA*

8-8-41

(Date)

(Title)

U. S. Department of Agriculture

NATIONAL FOREST

CORNERS OF THE PUBLIC SURVEY

*of corner*  
*55° E*

Give any further facts which will aid in finding this  
from which this corner bears  
side of  
tree 6 inches diameter, on the  
Metal Location Poster is on a

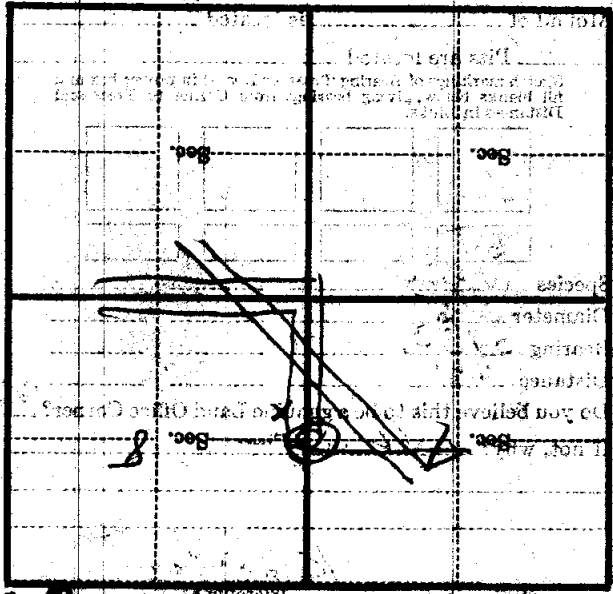

(Beats sketch of topography near corner)

U. S. Department of Agriculture  
FOREST SERVICE

~~8-5~~  
G-5

Chippewa NATIONAL FOREST

CORNERS OF THE PUBLIC SURVEY

T. 141 R. 25 5 Mer.

Corner common to Sections  
7, and 8

Corner consists of a (not) in place  
State condition

Dimensions above ground inches  
Sketch grooves, letters, figures, or notches, on proper face or edge.

CARDINAL POSITION

DIAGONAL POSITION

N	W	S	E

NW	SW	SE	NE

Mound of is located

Pits are located

Sketch markings of Bearing Trees (or Rocks) in proper box and fill blanks below, giving bearings from Corner to Trees and Distances in Links.

B.T.			

Species W. Pine  
Diameter Stump  
Bearing S 43 E  
Distance 49'

Do you believe this to be a genuine Land Office Corner? NO  
If not, why? Co. Corner

D. W. Campbell

(Signature)

Camp Supt.

8-8-41

(Date)

(Title)

Corner again.  
B.T. in field S. E. of corner.

Give any further facts which will aid in finding this  
41.6 ft. ~~corner~~ distant.  
from which this Corner bears  
side of S 51° E  
tree 6 inches diameter, on the S. E.  
Metal Location Poster is on a Elm

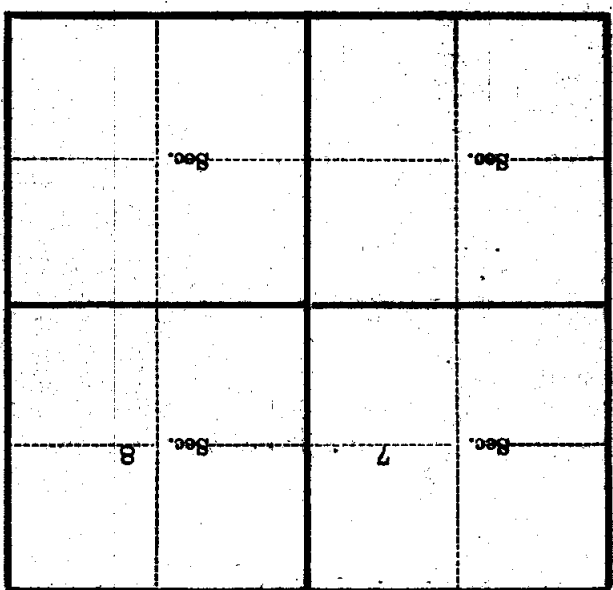

(Make sketch of topography near Corner)